

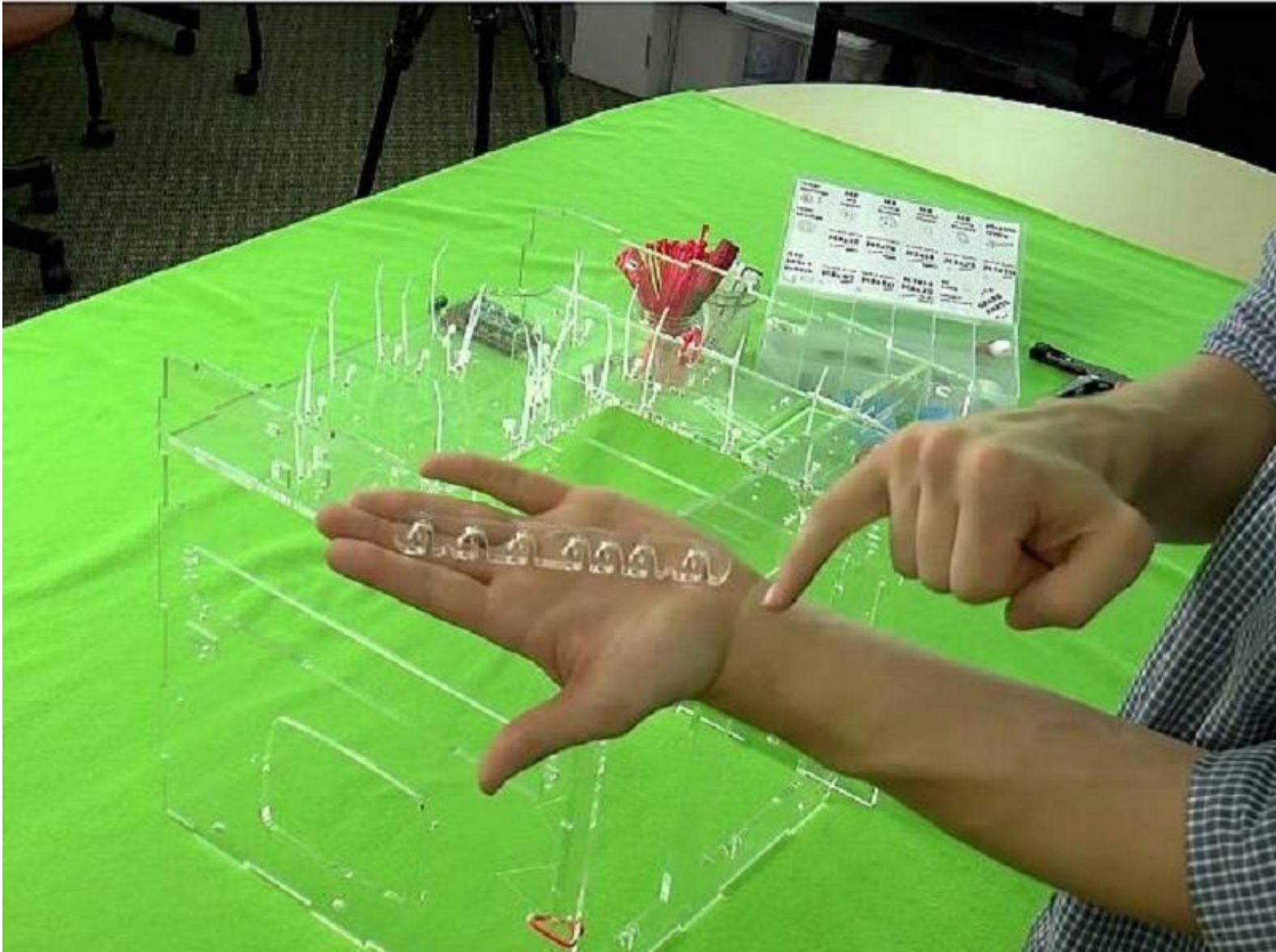

Zip Ties + Wire Comb

In this guide, we prepare the inner back for the following wiring steps.



INTRODUCTION

[video: <https://www.youtube.com/watch?v=ePKqwVfAsn0>]

Step 1 — You'll need:

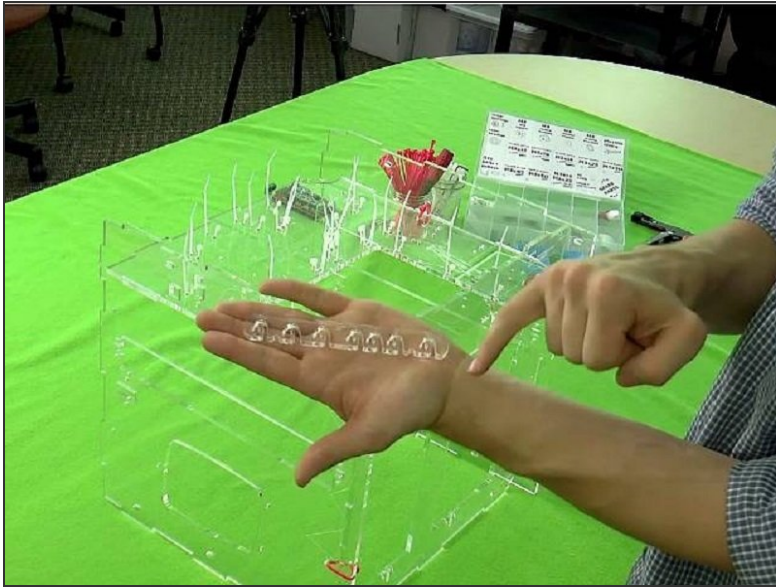

- JellyBox box
- 4" zip ties
- Wire comb

Step 2 — Pre-Install Zip Ties

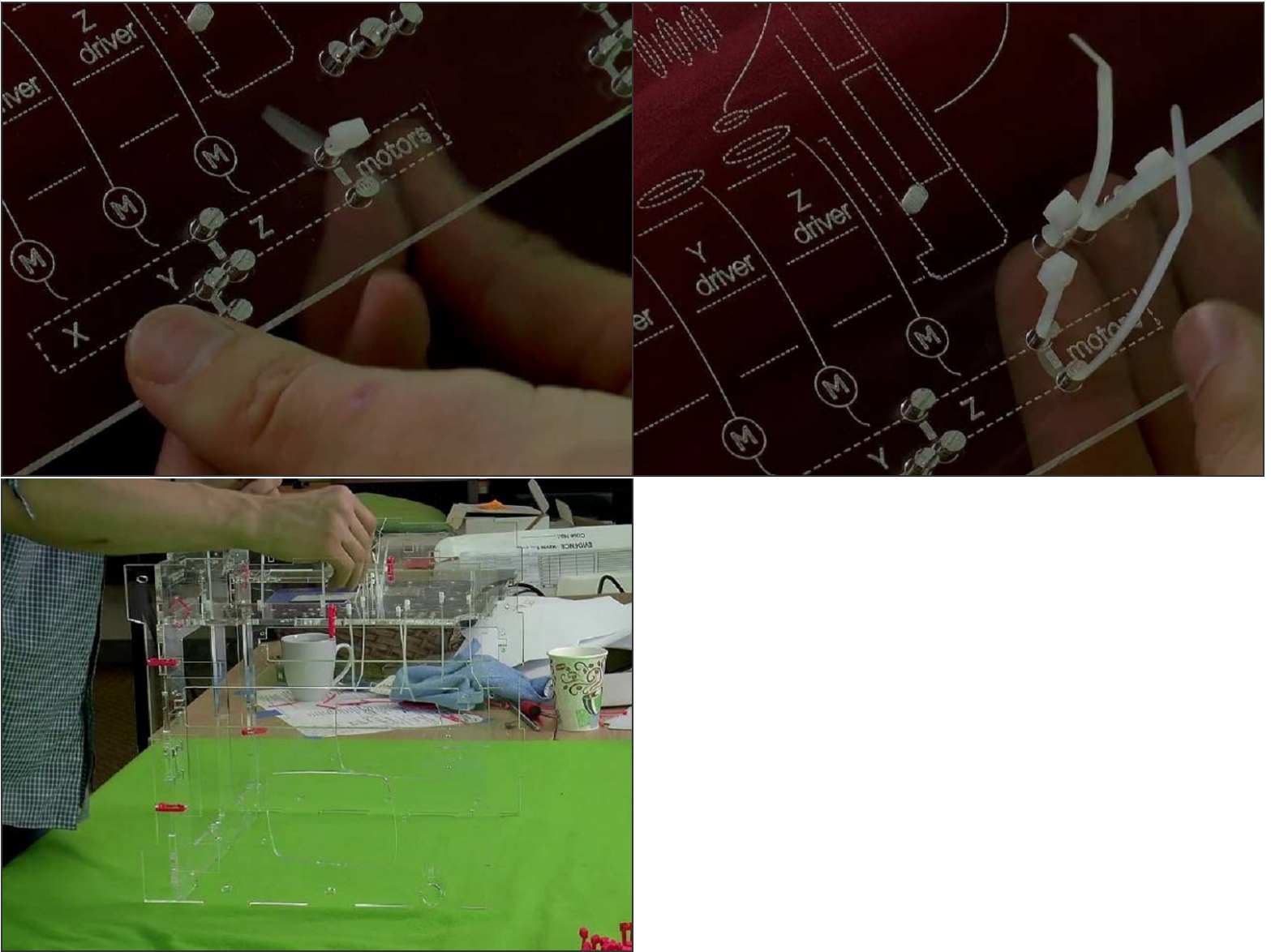

- Insert 4" zip ties with the head on the outside (facing you) anywhere where there is a pair of holes 'connected' with an etching.
- Tip: It is more efficient to first drop all the zip ties in all the holes and then pull them all back through! Energize.
- Note: two groups of 3 holes close to the center of inner back fit two zip ties - the middle hole is shared.

Step 3 — Attach the Wire Comb

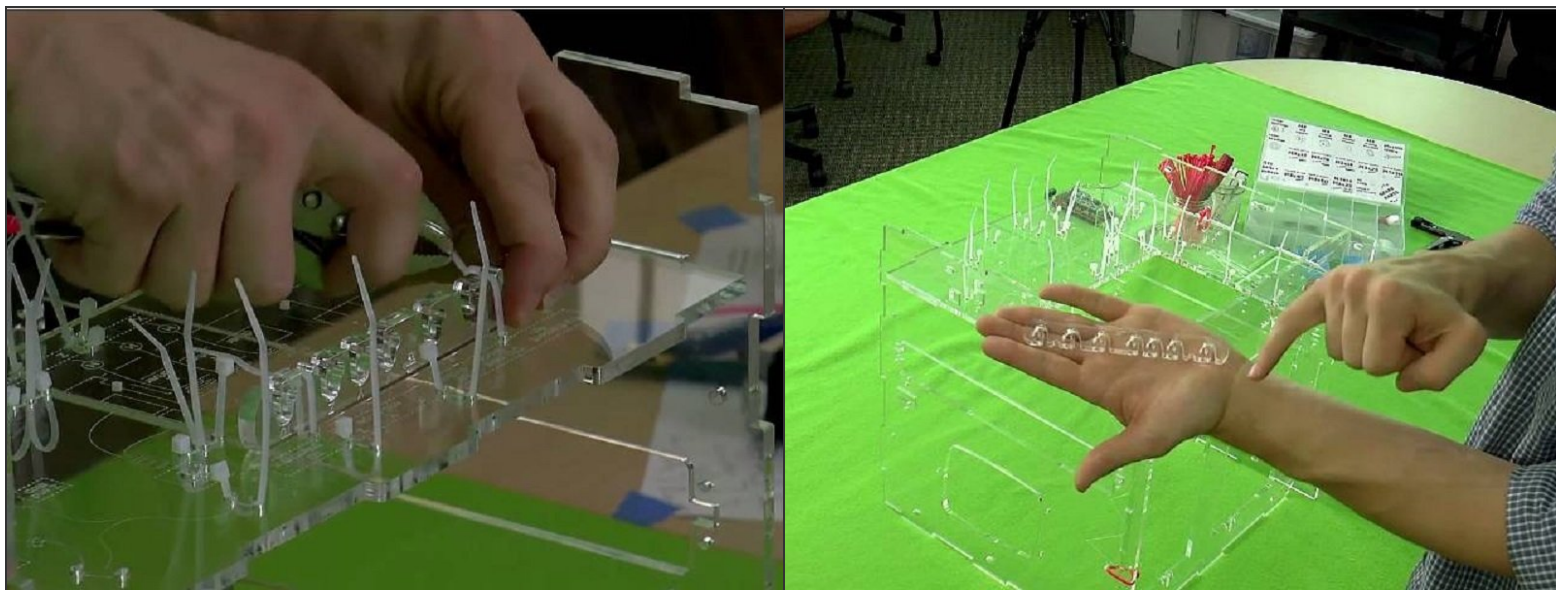

- Align the wire comb with the corresponding annotations (ie. filament fan, heat block, etc.), and secure it with a zip tie.
- Tip: Cut the zip ties connecting the wire comb immediately to reduce visual complexity.