

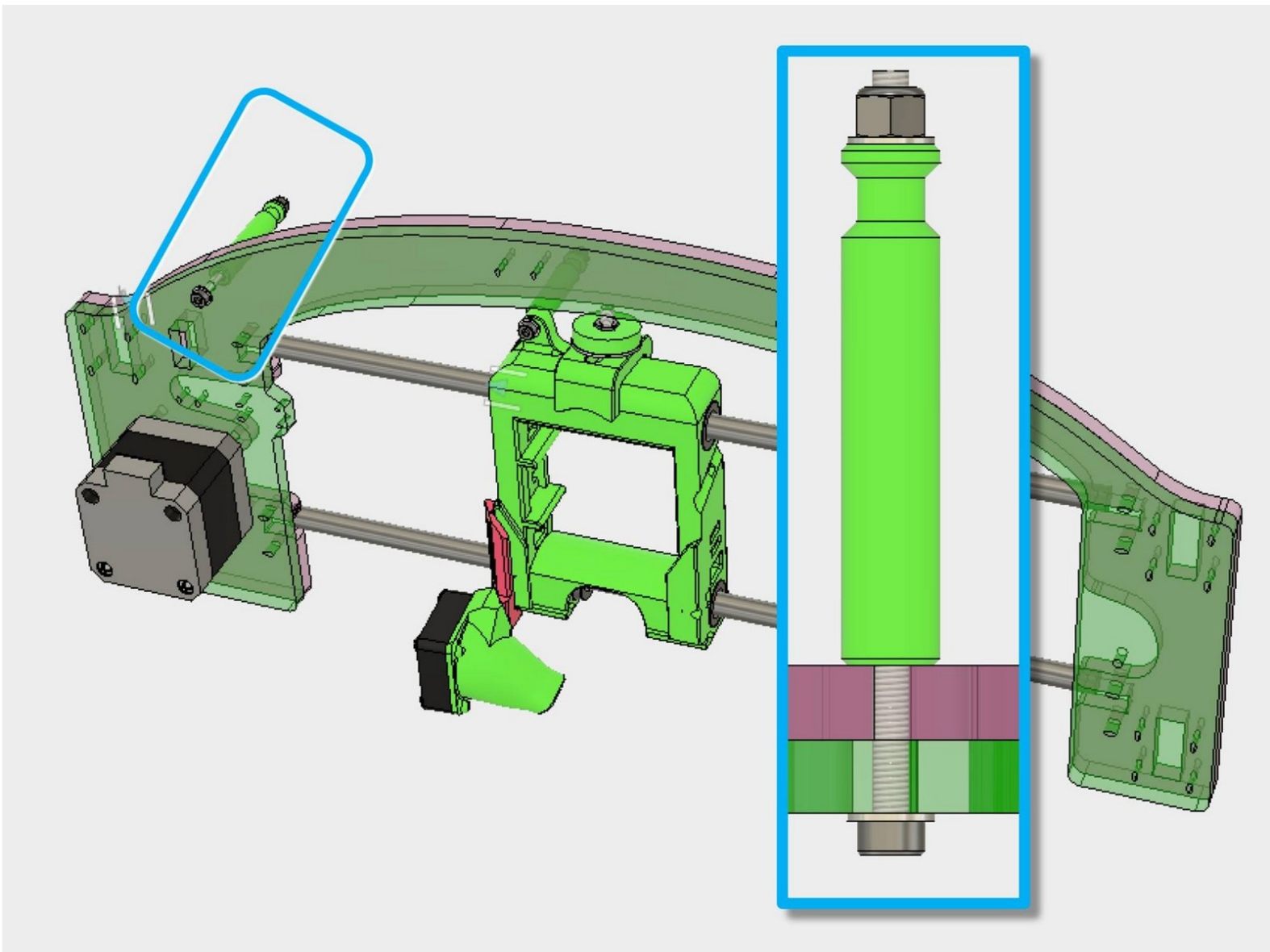

## 4. Wire Stand-offs

In this guide, we prepare two stand-offs = spacers on which we'll then attach all the x assembly wires.



## INTRODUCTION

[video: [https://youtu.be/q59yprd\\_IFo](https://youtu.be/q59yprd_IFo)]

## Step 1 — For Attaching the Wire Stand-Offs You'll Need:

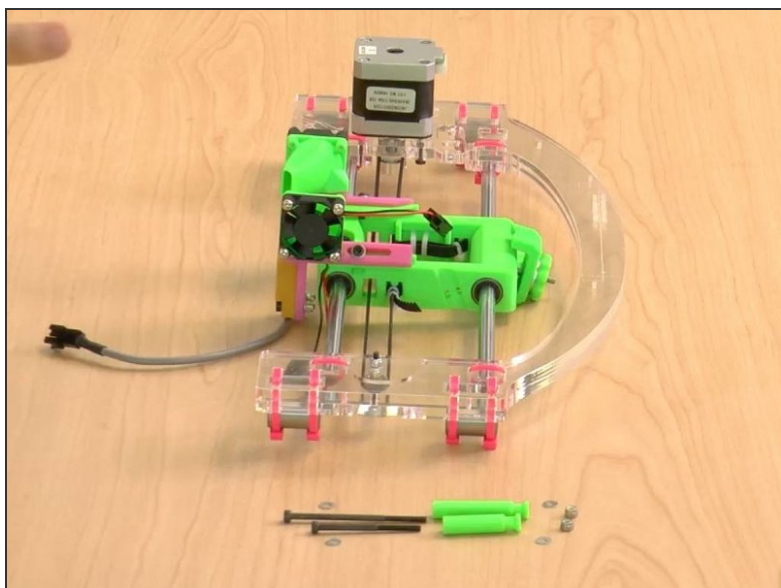

- Short Stand-Off(=spacer) (1)
- Long Stand-Off (= spacer) (1)
- M3x45 bolt (1)
- M3x60 bolt (1)
- M3 regular washer (4)
- M3 nylon lock nut (2)

## Step 2 — The Long Stand-Off Order of parts:

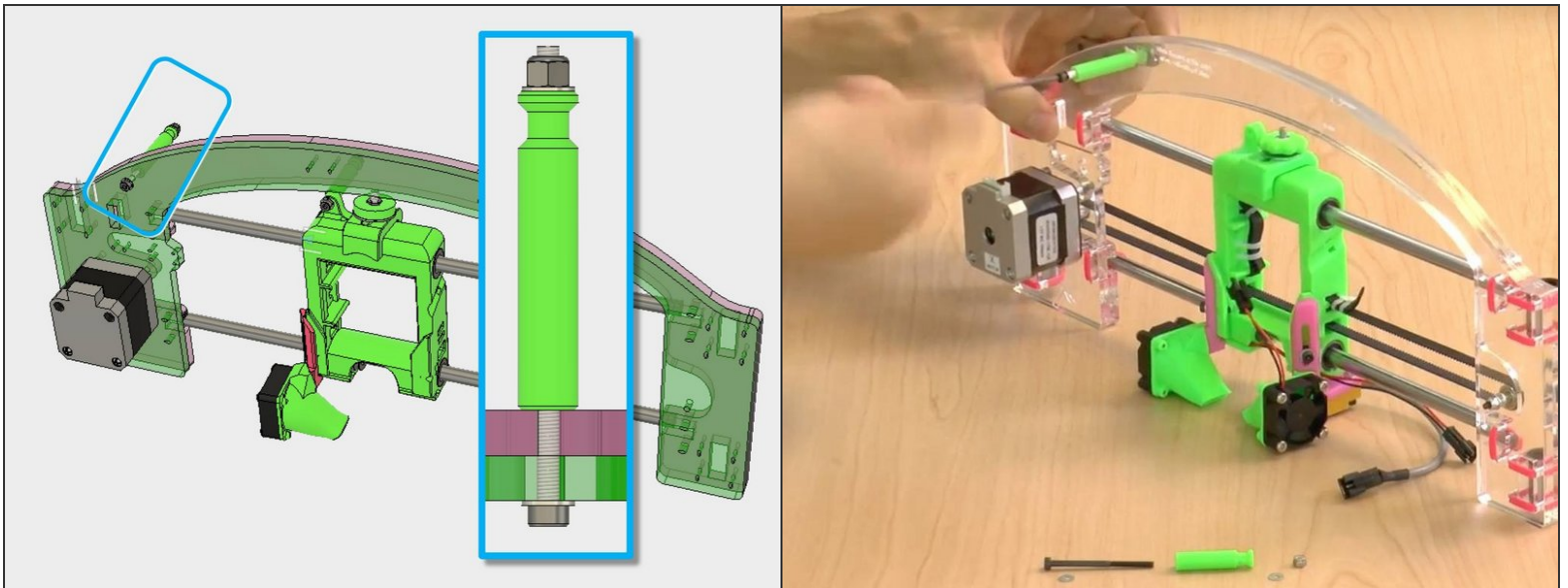

- Nylock locknut
- Regular washer
- Long green stand-off
- Acrylic Frame Pieces
- Regular washer
- M3x60 socket screw

### Step 3 — The Short Stand-Off Order of parts:

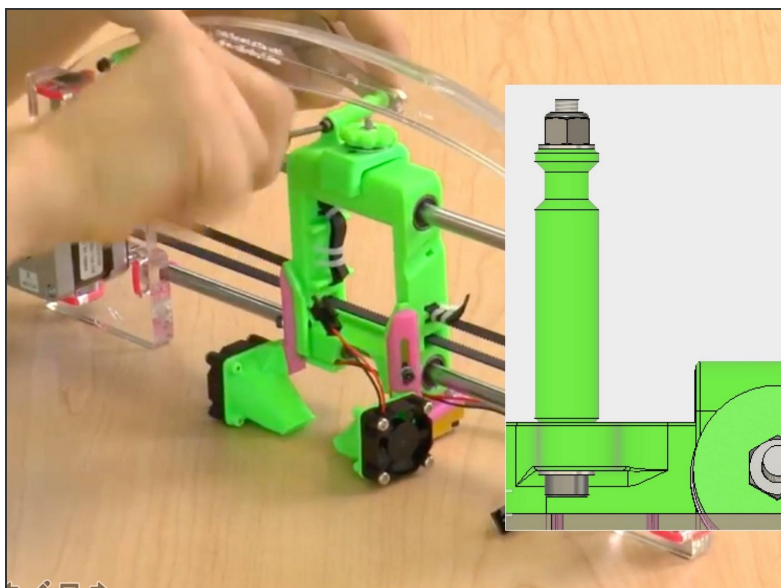

- Nylock locknut
- Regular washer
- Long green stand-off
- Green X-carriage
- Regular washer
- M3x45 screw