

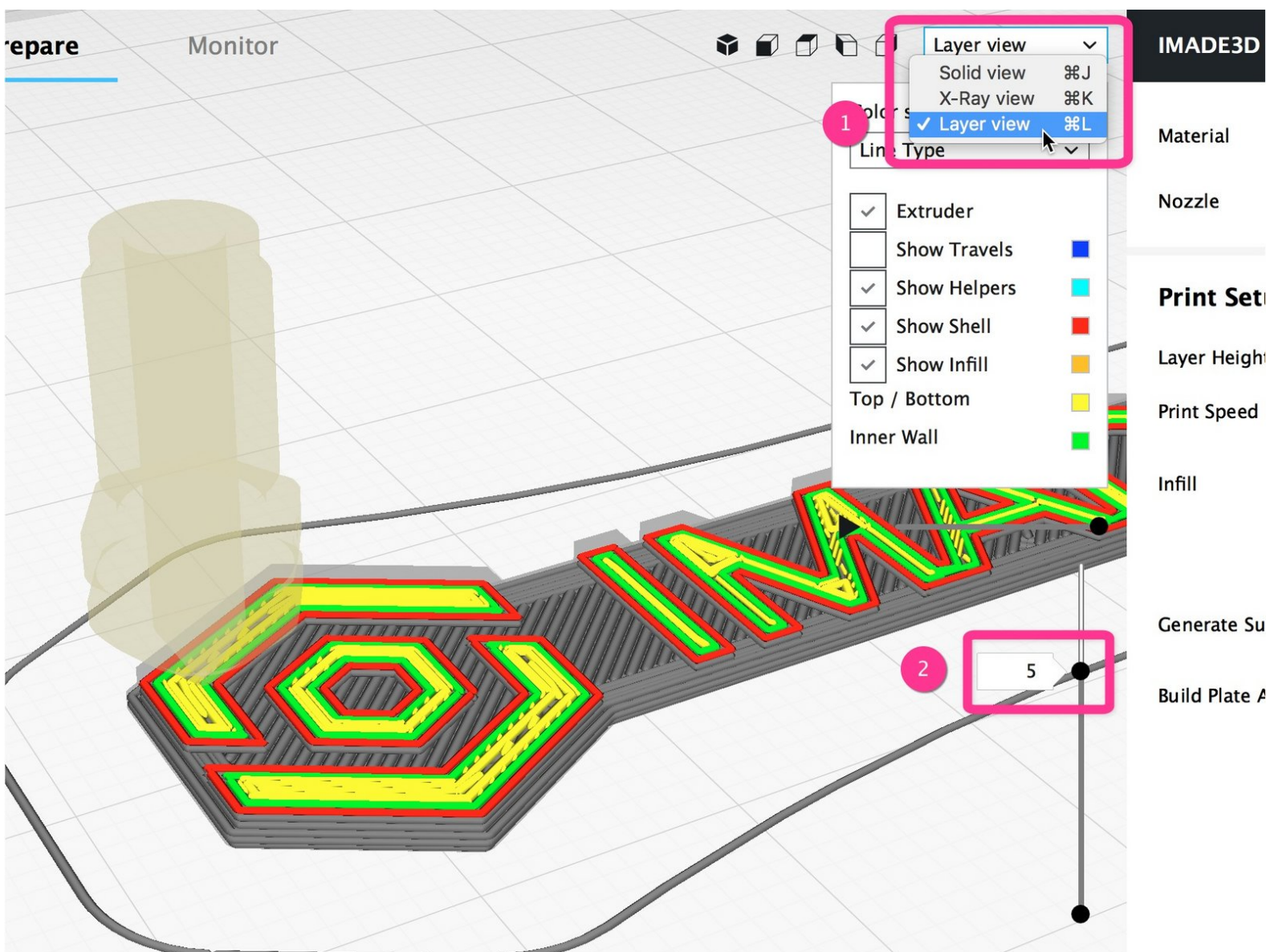

## 02. Cura 3 Slicer Quick Start Guide

You want to start slicing and printing your 3D models of Your choosing as fast as you can.  
Herein lies the magic.



## Step 1 — Download and Install Cura

### Install

1. Head over to <http://go.imade3d.com/cura>
2. Download the latest available Cura IMADE3D Edition
3. Drag **Cura IMADE3D Edition.app** into your Applications folder.

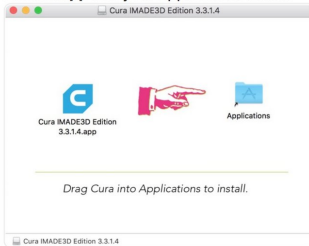

4. Start **Cura IMADE3D Edition**. If you see this splash screen, you're good to go into **Initial Setup**. If you see anything else, continue with **Troubleshooting** (at the bottom of this document.)



- Don't have Cura yet? Head over to our [Cura Download and Installation instructions](#).

## Step 2 — Cura Quick Start Guide

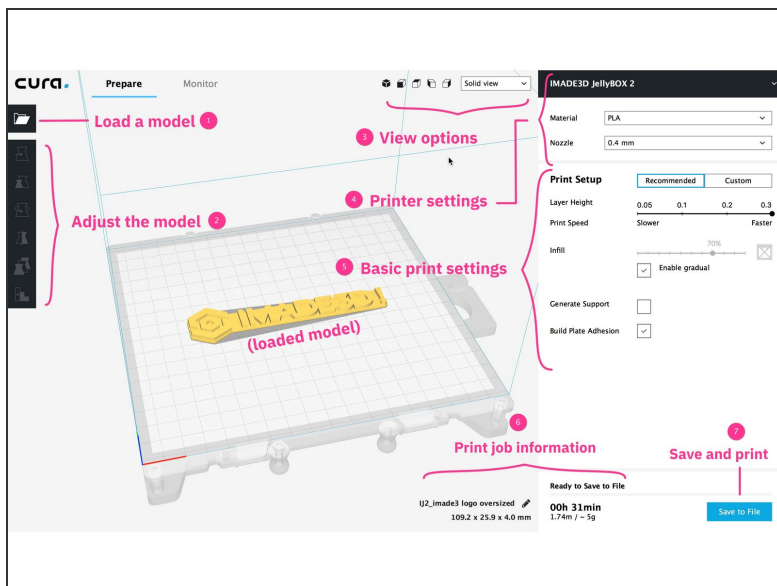

- Our [Cura Quick Start Guide](#) will get you started.

## Step 3 — Discovery Place Workbook

<b>Dreams.stl</b> Source: <a href="https://www.thingiverse.com/thing:2195561">https://www.thingiverse.com/thing:2195561</a>	
<b>Time Estimate:</b>	
<b>Material Estimate:</b>	
<b>Cost Estimate:</b>	
<b>Change to Object Scale?</b> Default: 100%	
<b>Profile: Speed vs. Detail</b> Default: Medium (0.2m)	
<b>Infill: Interior Structure</b> Default: 70% Cubic or 20% ZigZag	
<b>Shell: Exterior Structure</b> Default: 0.8	
<b>Is Support Required?</b> Default: Off	
<b>Is Brim Required?</b>	

- Here's a [Cura 3 workbook](#) from Joel Bonasera from Discovery Place in Charlotte, NC.
- This workbook has simple interactive tasks to get you going in Cura. Joel uses it in his F2F workshops.