

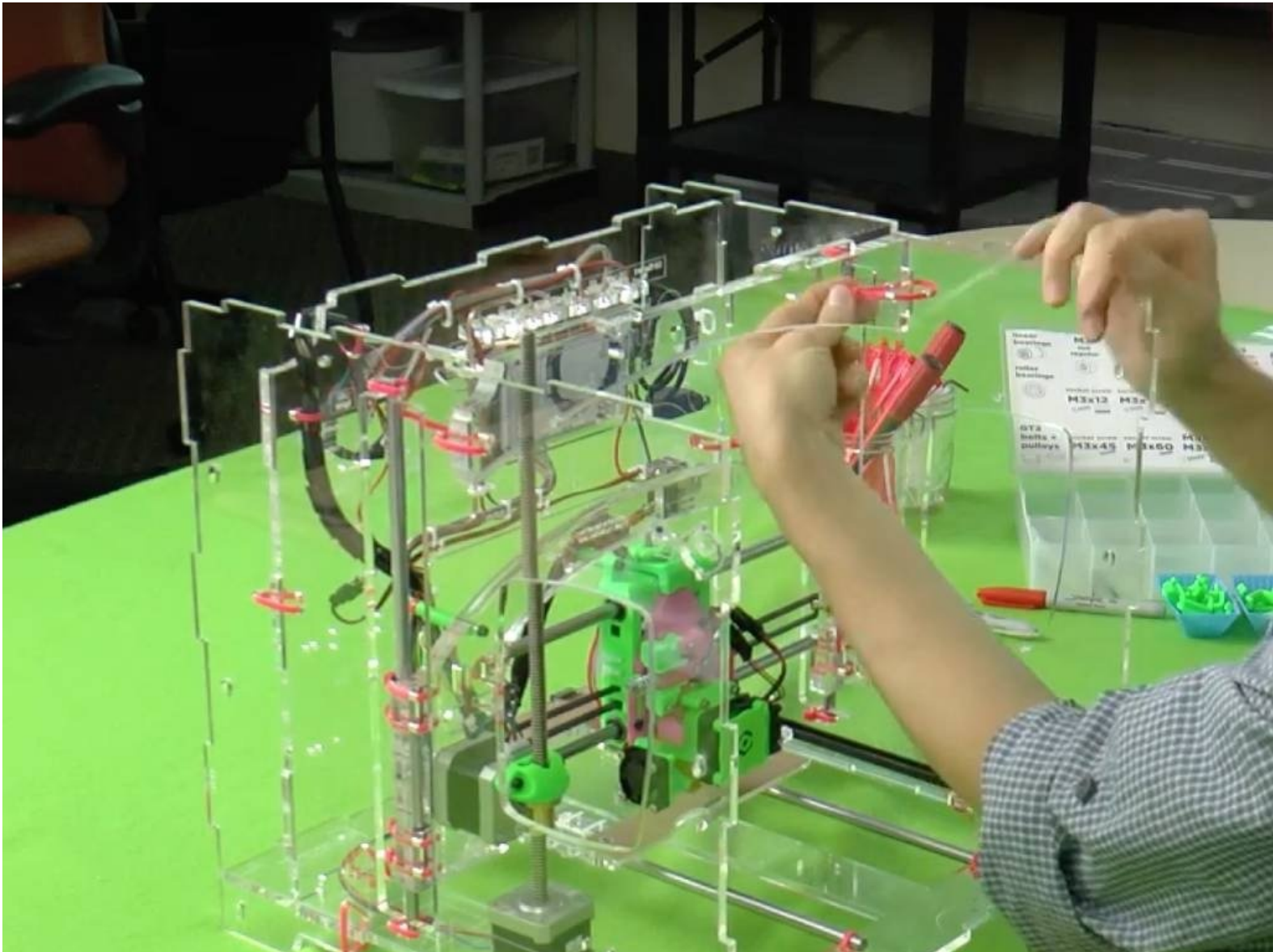

# Brace

In this guide, we assemble and incorporate the Brace.



# INTRODUCTION

In this guide, we assemble and incorporate the Brace.

## Step 1 — You'll Need:

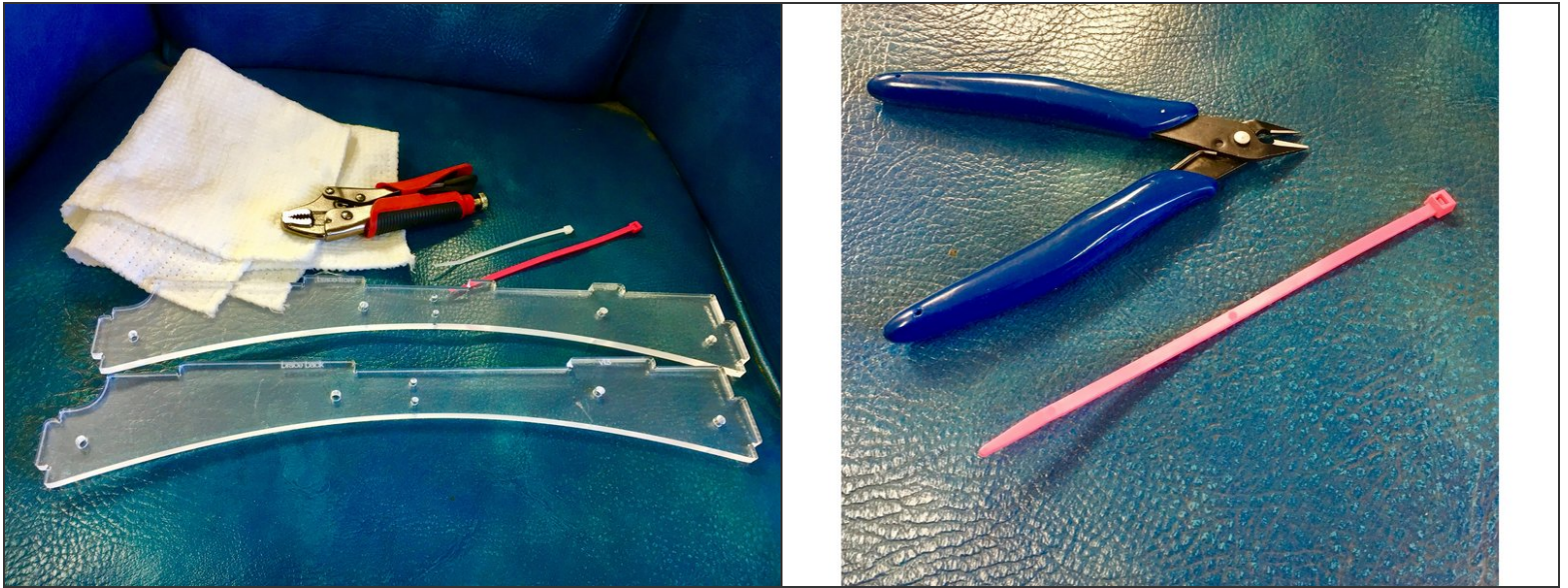

- Front Brace piece
- Back Brace piece
- 4" zip tie (1)
- 6" zip tie (2)
- Vise Grip
- Side Cutters
- A soft cloth



## Step 2 — Clean the Brace

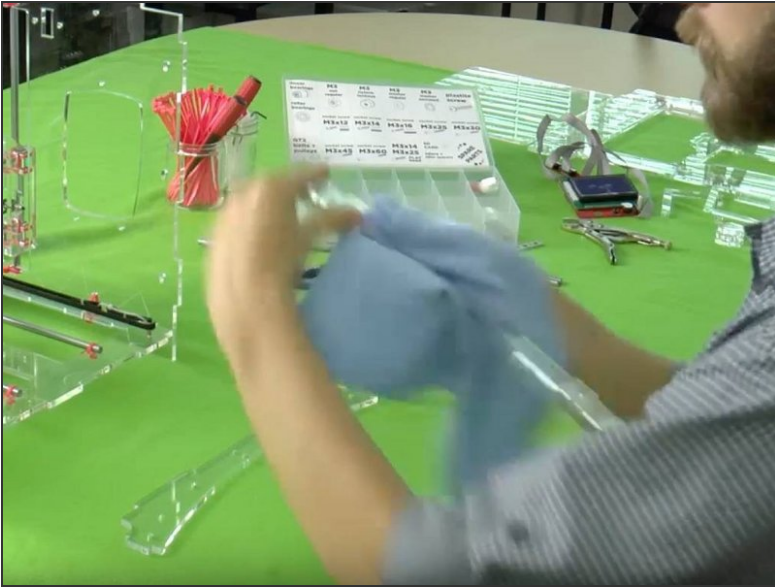

- Use a soft cloth to clean the brace parts.
- Any fingerprints or dirt stuck between the two will show.

## Step 3 — Align the Brace Parts

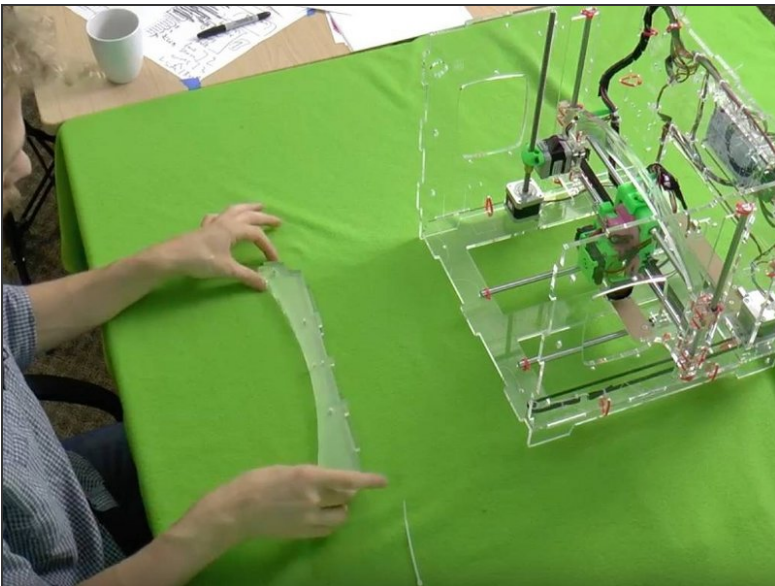

- Place the front brace on top of the back brace.

## Step 4 — Connect the Brace Pieces

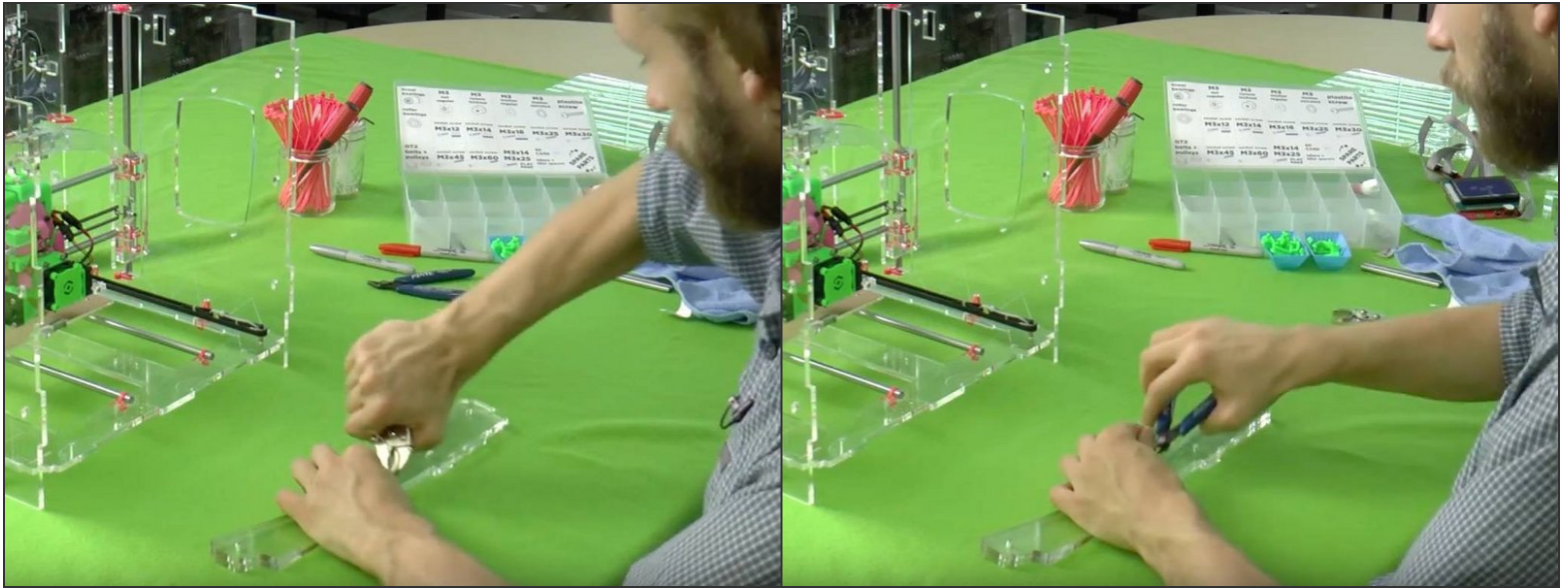

- Use a 4" zip tie through the two central holes.
- Tighten the zip tie with vice grips.
- Cut the free end with side cutters.

## Step 5 — Place the Brace in the Printer

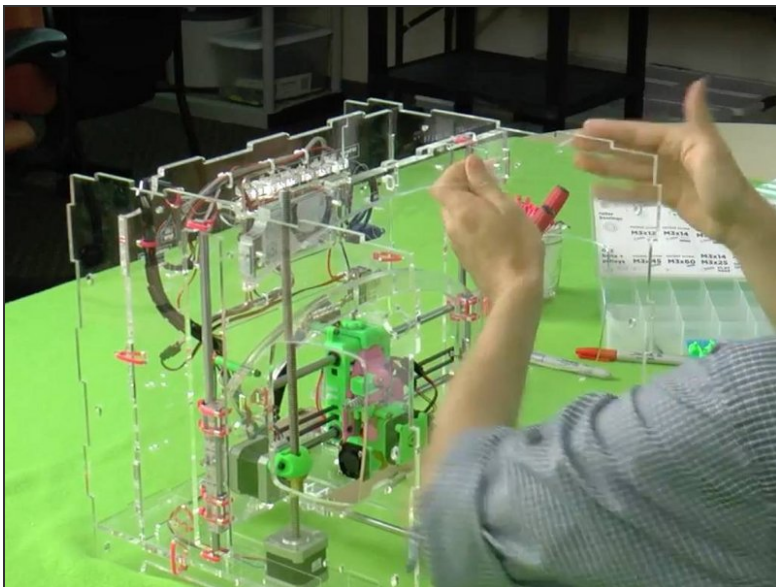

- Gently flex left and the right acrylic pieces to put the brace into position.
- (See video if necessary!)
- Make sure the cut out in the brace is on the left side.

## Step 6 — Secure the Brace with Zip Ties

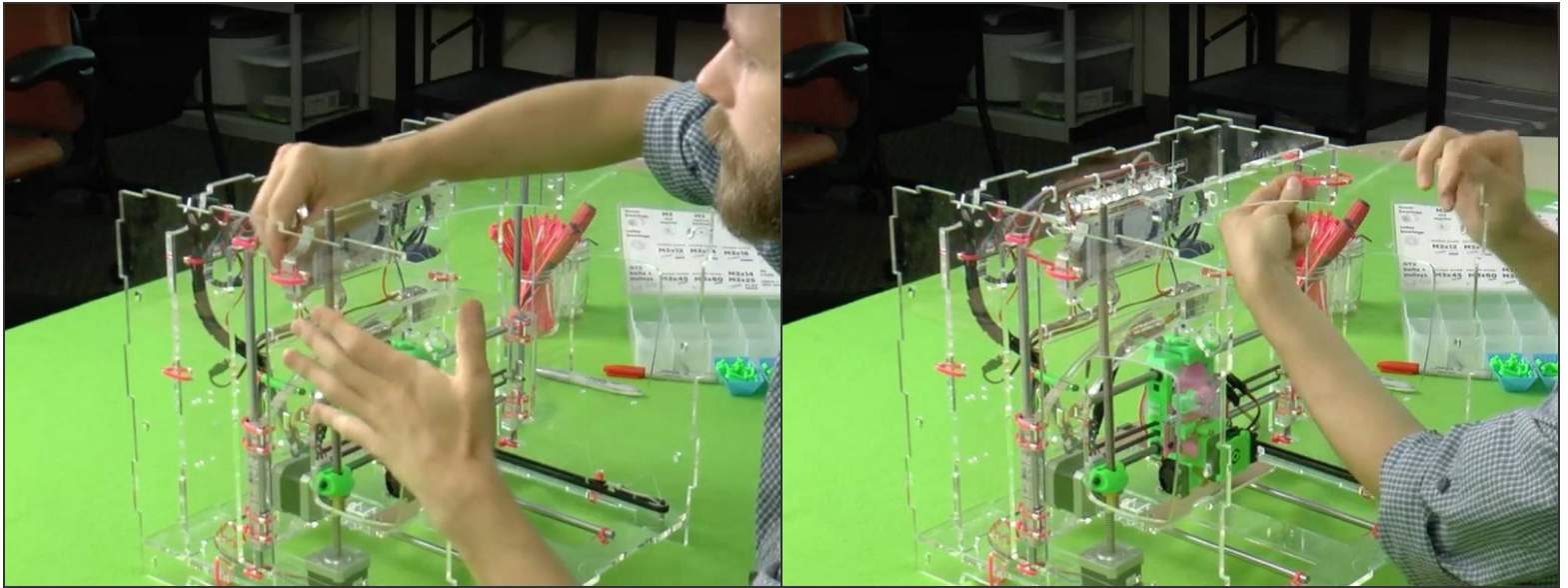

- Use two 6" zip ties to hold the brace in place.
- Place the heads of the ties behind the brace.
- Use vice grips and side cutters to tighten and clean up the connection.