

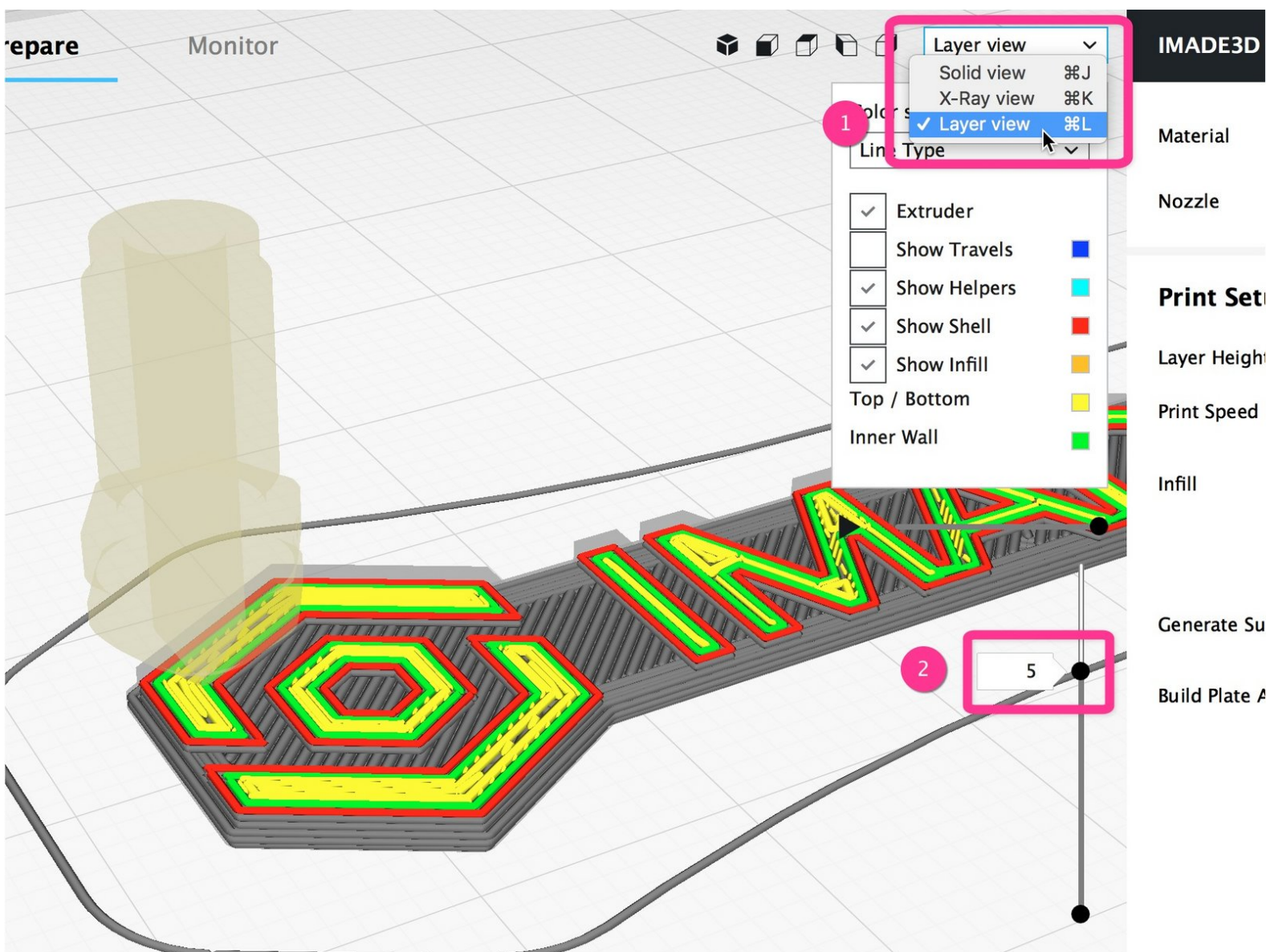

02. Cura 3 Slicer Quick Start Guide

You want to start slicing and printing your 3D models of Your choosing as fast as you can.
Herein lies the magic.



Step 1 — Download and Install Cura

Install

1. Head over to <http://go.imade3d.com/cura>
2. Download the latest available Cura IMAD3D Edition
3. Drag **Cura IMAD3D Edition.app** into your Applications folder.

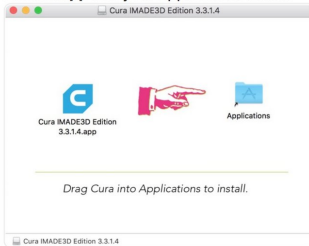

4. Start **Cura IMAD3D Edition**. If you see this splash screen, you're good to go into **Initial Setup**. If you see anything else, continue with **Troubleshooting** (at the bottom of this document.)



- Don't have Cura yet? Head over to our [Cura Download and Installation instructions](#).

Step 2 — Cura Quick Start Guide

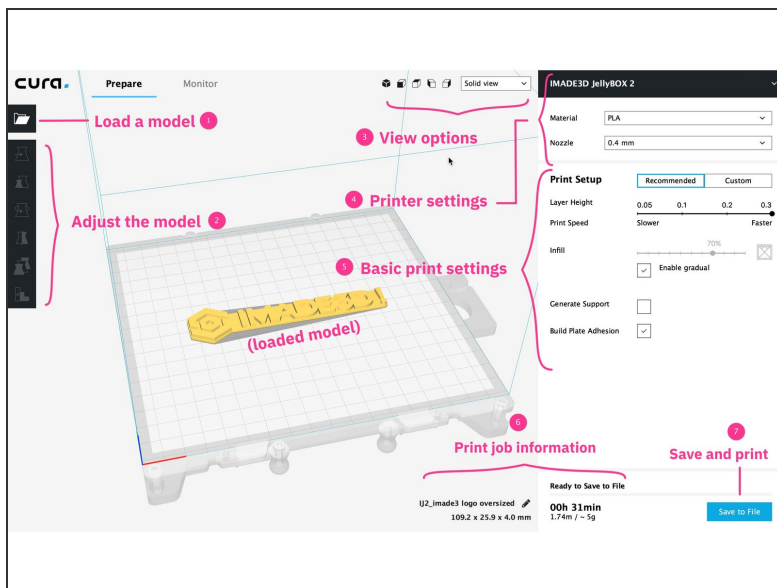

- Our [Cura Quick Start Guide](#) will get you started.

Step 3 — Discovery Place Workbook

Dreams.stl

Source: <https://www.thingiverse.com/thing:2195561>

Time Estimate:

Material Estimate:

Cost Estimate:



Change to Object Scale?

Default: 100%

Profile: Speed vs. Detail

Default: Medium (0.2m)

Infill: Interior Structure

Default: 70% Cubic or 20% ZigZag

Shell: Exterior Structure

Default: 0.8

Is Support Required?

Default: Off

Is Brim Required?

- Here's a [Cura 3 workbook](#) from Joel Bonasera from Discovery Place in Charlotte, NC.
- This workbook has simple interactive tasks to get you going in Cura. Joel uses it in his F2F workshops.