

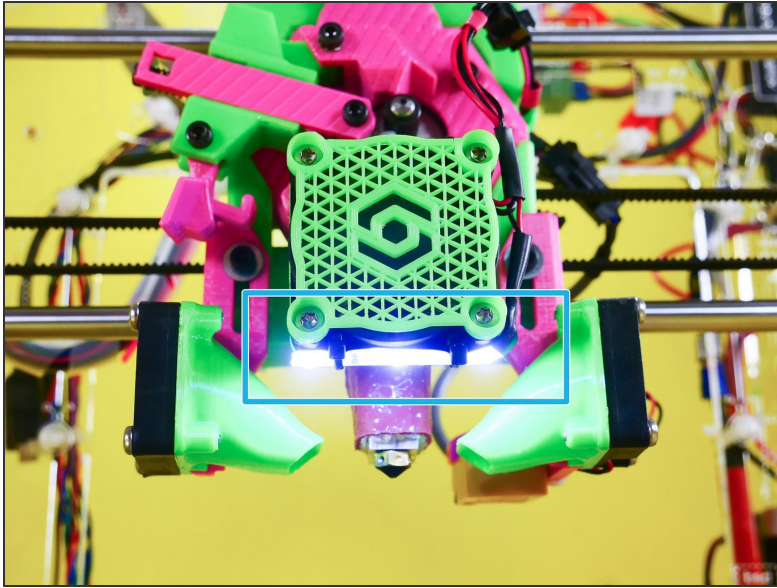

02. ✓ Preflight Check: All Systems Go!



Step 1 — Do you see the light?



- The led strip should light up when you turn your JellyBOX on.

Step 2 — Is the hotend fan spinning?

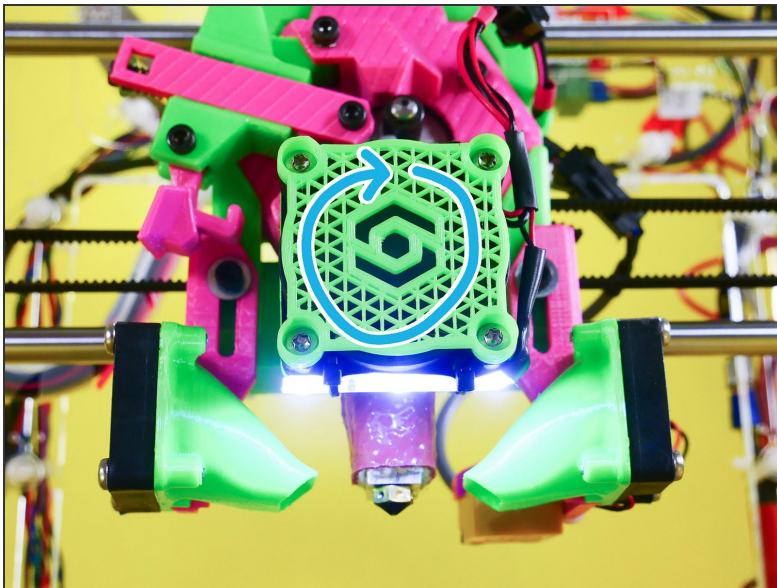

- When your JellyBOX is on, you should hear and see the hotend fan spinning.
- Else the hotend will eventually overheat and you will get a terrible print quality or a even clogged hotend.

Step 3 — Maintenance > Preflight Check

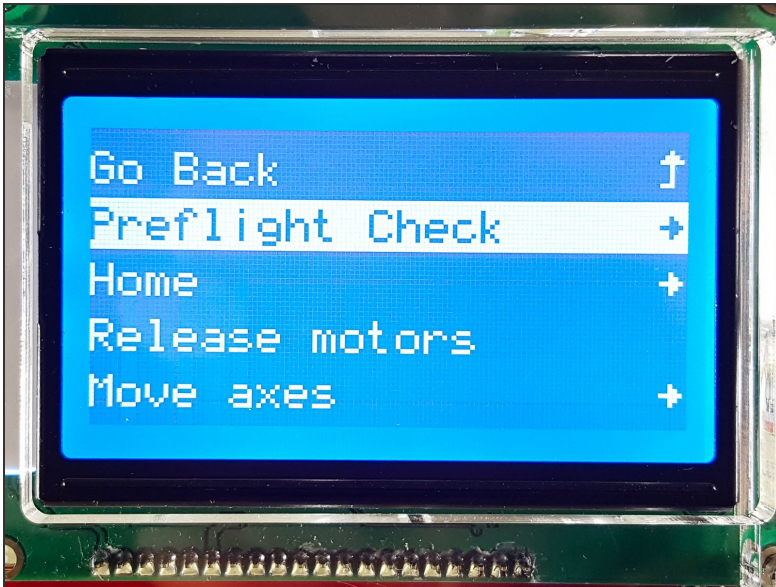

- The rest of the Preflight Check is conveniently pre-cooked in your JellyBOX.
- Go to **Maintenance > Preflight Check** and go down the list.

Step 4 — ↳ 1. Test the motors

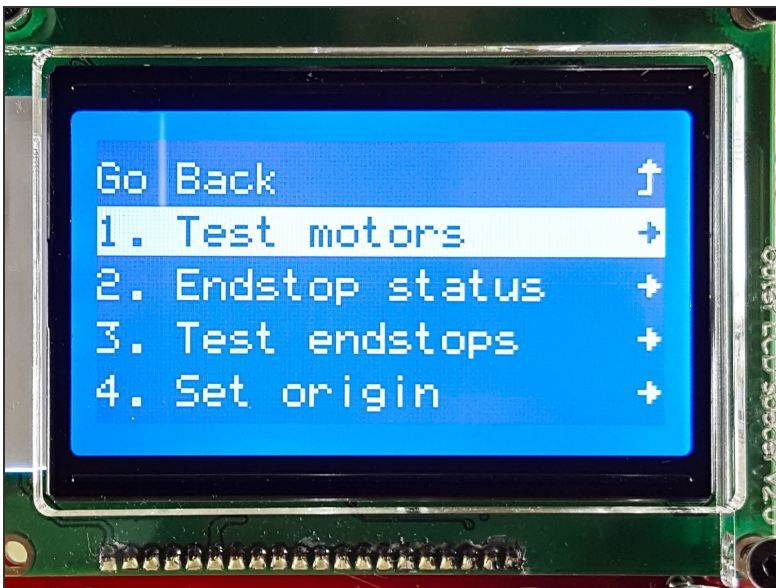

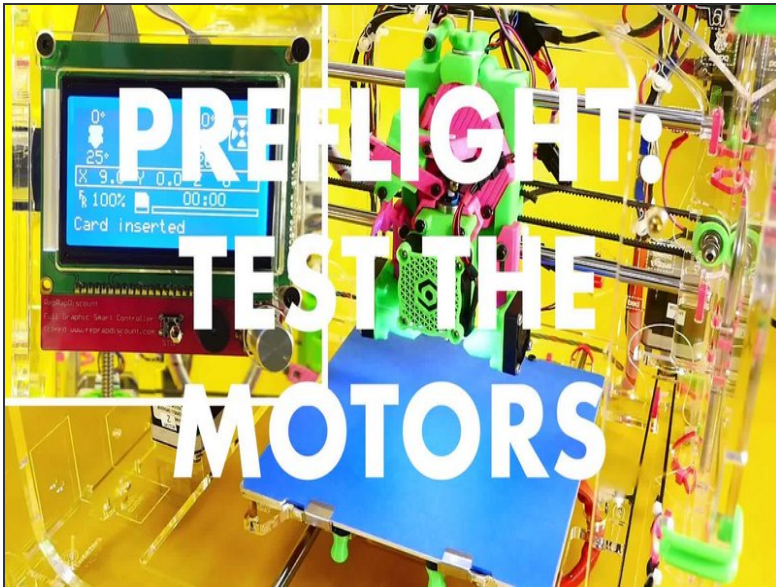
Step 5 — ▶ Video: Test the Motors

- ▶ Video: Test the Motors

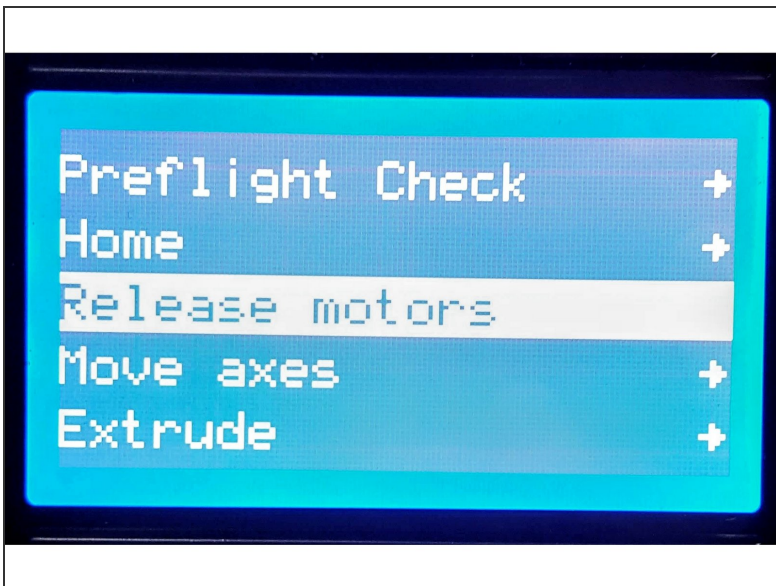
Step 6 — ↳ 2. Check the Endstop Status

- Prerequisite: Release the motors so that you can move them by hand freely.
- **Maintenance > Release motors**

Step 7

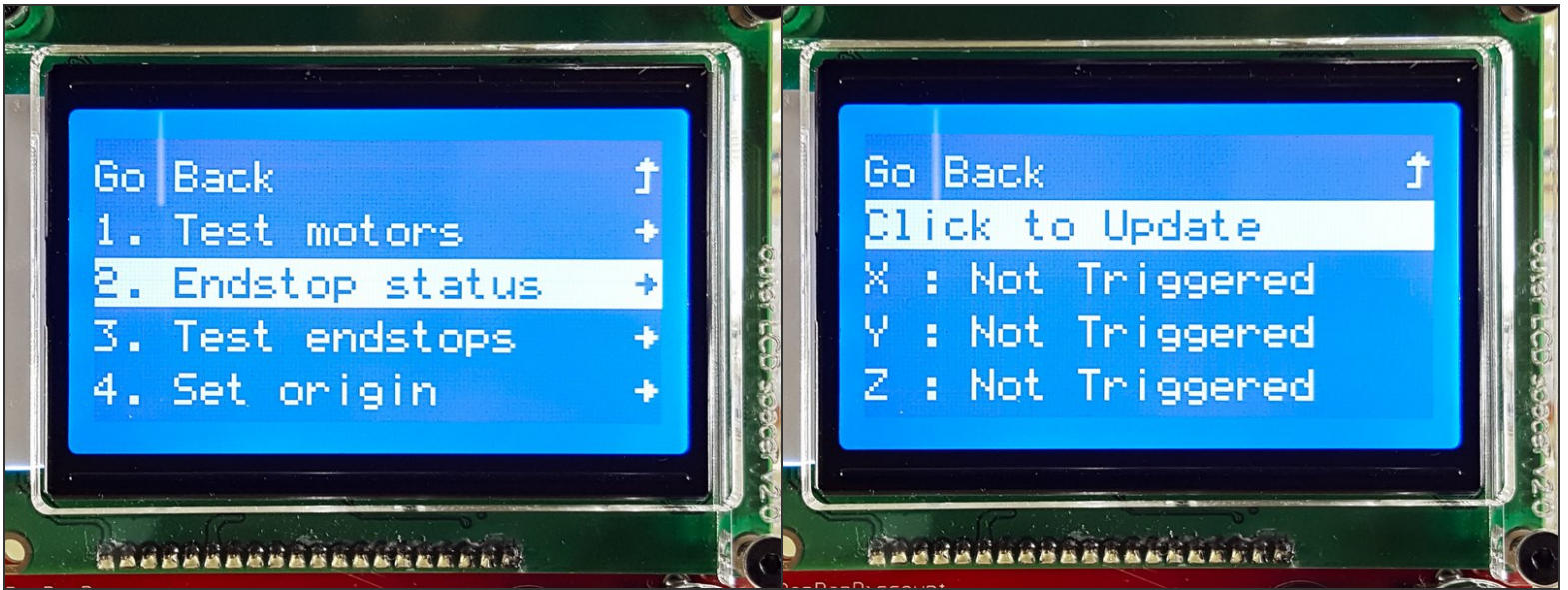

- Insert wisdom here.

Step 8 — ► Video: Check the Endstops

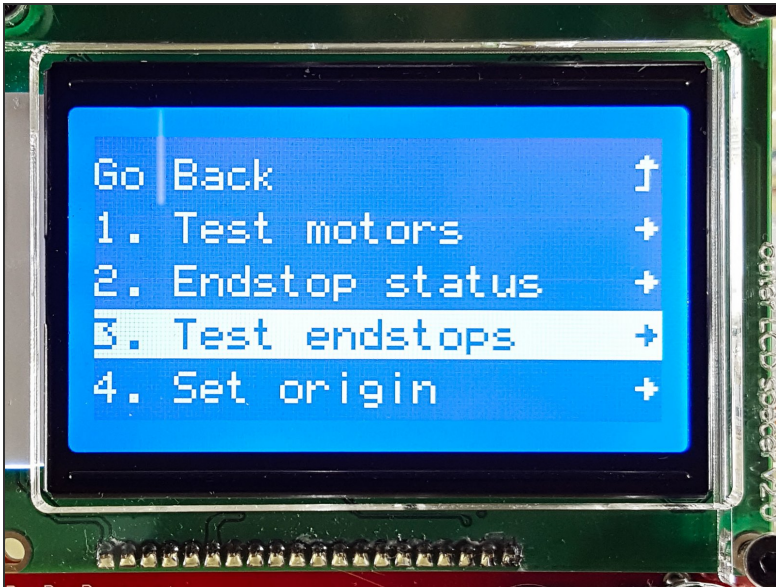
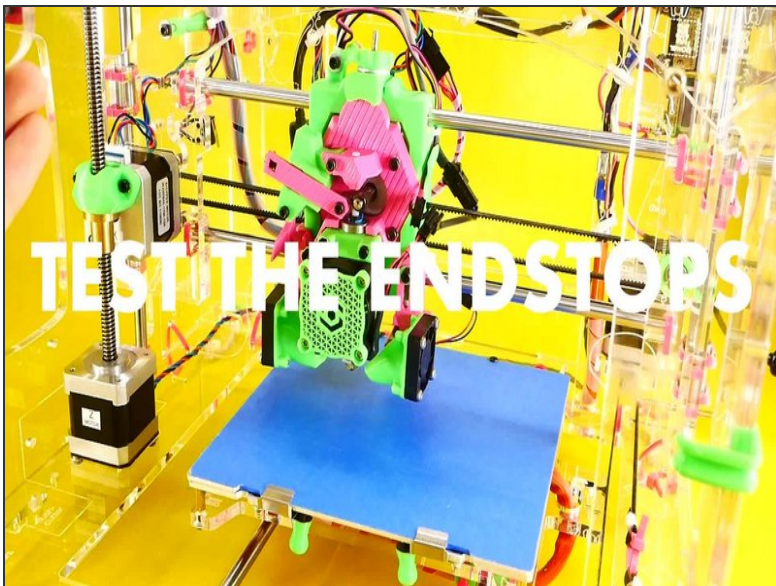

- ► Video: Check the Endstops

Step 9 — ↩ 3. Test the endstops**Step 10 — ▶ Video: Test the Endstops**

● ▶ Video: Test the Endstops

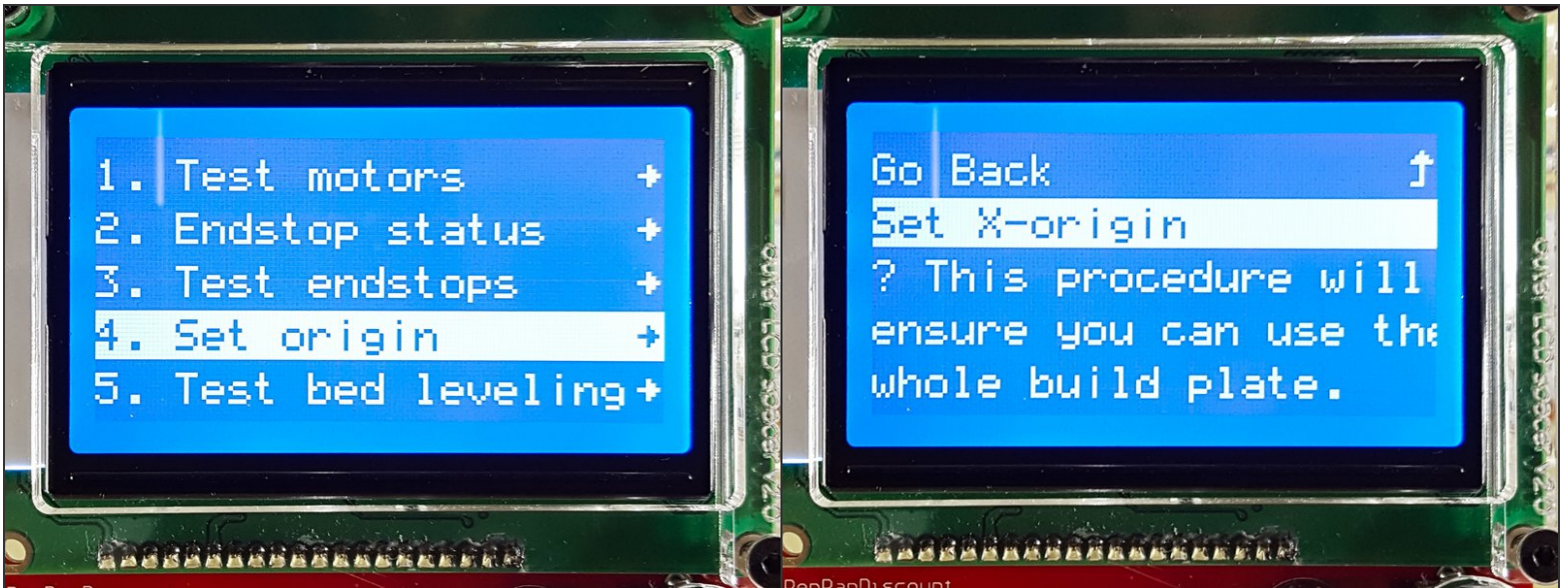
Step 11 — ↪ 4. Set the X origin

- Insert wisdom here.

Step 12 — ► Video: Set the X-Origin

- ► Video: Set the X-Origin

Step 13 — ↳ 5. Test auto bed leveling

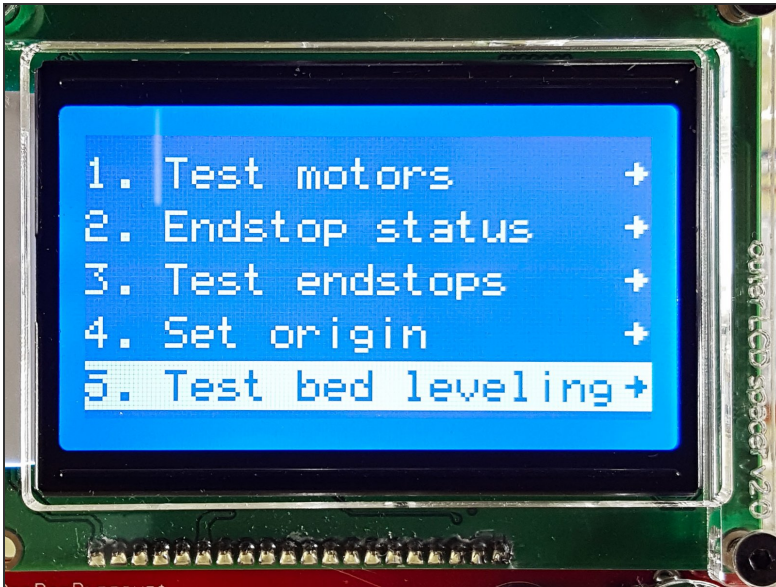

Step 14 — ↳ 6. Test the nozzle heater

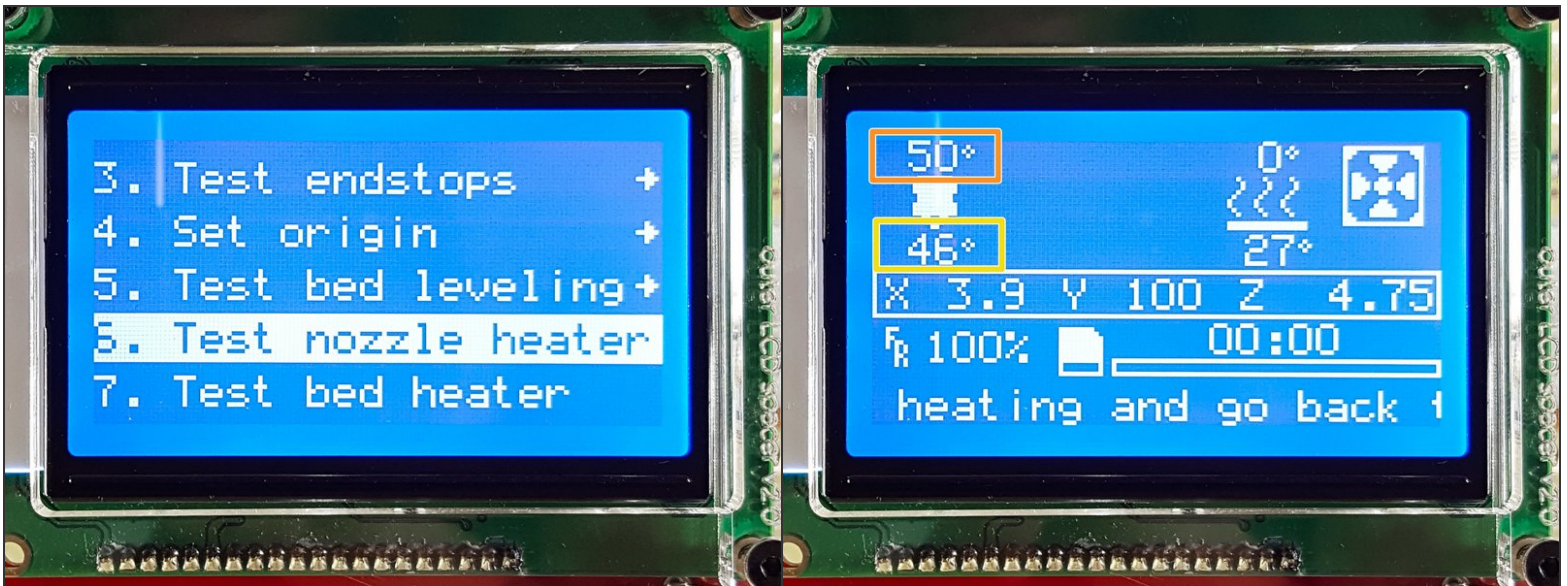

- Make sure the *hotend* temperature is rising, then click to continue the Preflight.
- Target temperature
- Current temperature

Step 15 — ↳ 7. Test the bed heater

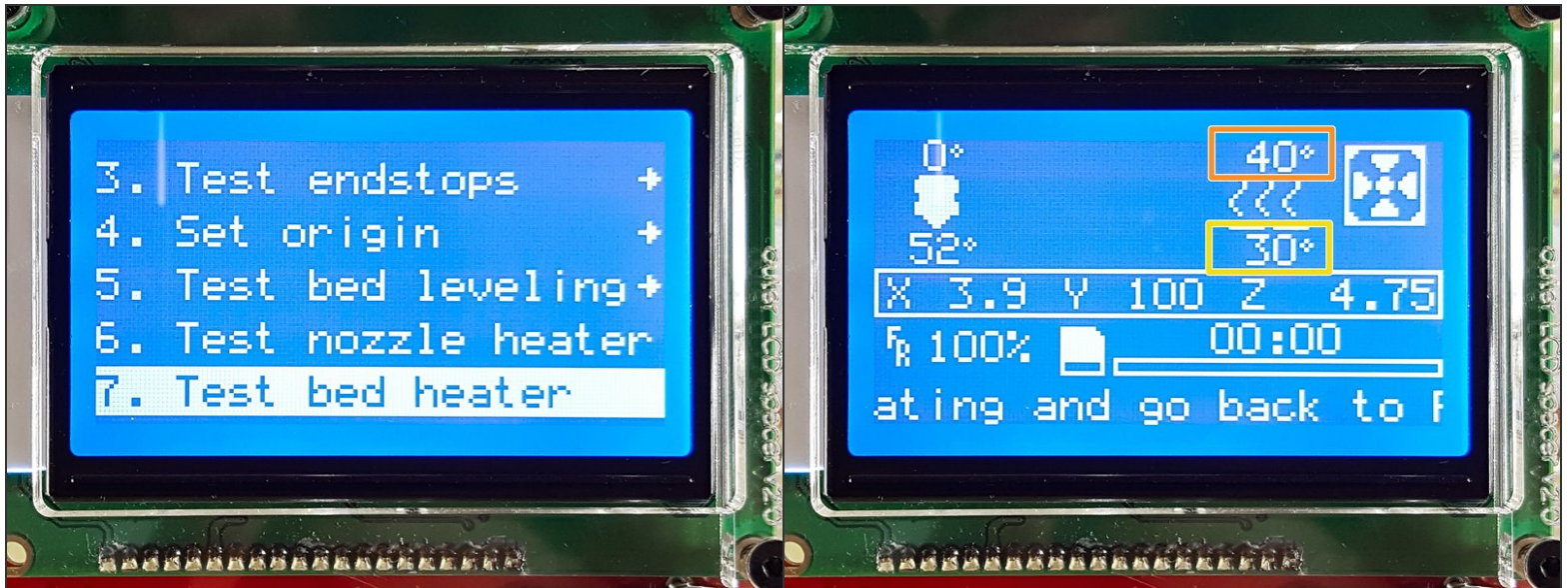

- Make sure the *bed* temperature is rising, then click to continue the Preflight.
- Target temperature
- Current temperature

Step 16 — ↳ 8. Test filament fans

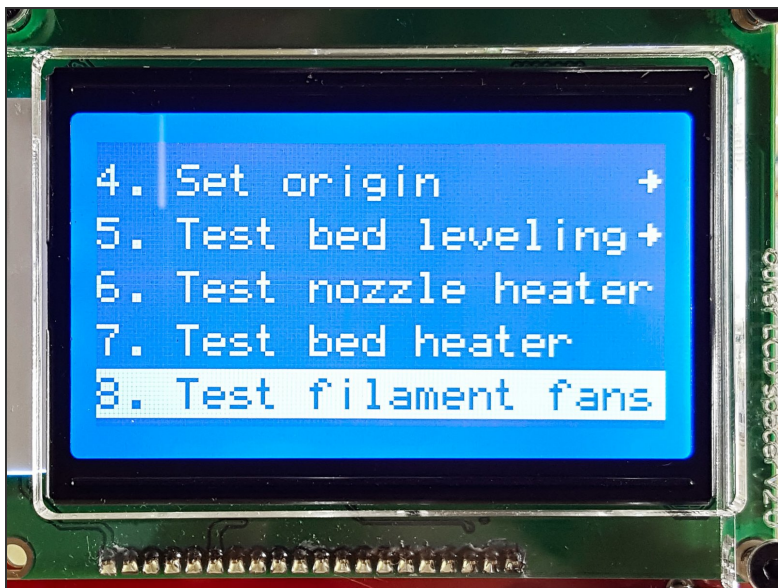

- The filament fans should spin up and then slow down again.

Step 17 — PS:

- PS: Your Preflight Check may still have items *9. Load Filament* and *10. Eject Filament*. Simply SKIP THESE for now. We will load and eject filament a bit later as a part of your First Print.
- These functions will be removed from the Preflight Check in the future. They are identical to the Load and Eject functions available through the Material Menu.