



A detailed view of the internal components of a 3D printer, showing the electronics board, motors, and various sensors housed within a transparent acrylic enclosure. Two hands are visible holding the sides of the enclosure. The image shows a complex arrangement of wires, a main control board, and various mechanical parts. Labels are visible on the acrylic panels, including "D9 filament fan", "D10 heat block", "E0 motor", "X motor", "X & Z end stops", "TO 4mm thermistor", "12V aux power", "12V DC power", "USB", "support: www.made3d.com", "model: jerry3d 2", and "serial #:". The printer is built on a black base plate.

INTRODUCTION

Not the guide you are looking for?

Go back to the [← Easy Kit Build Flow.](#)

Step 1 — TEST Duplication Source

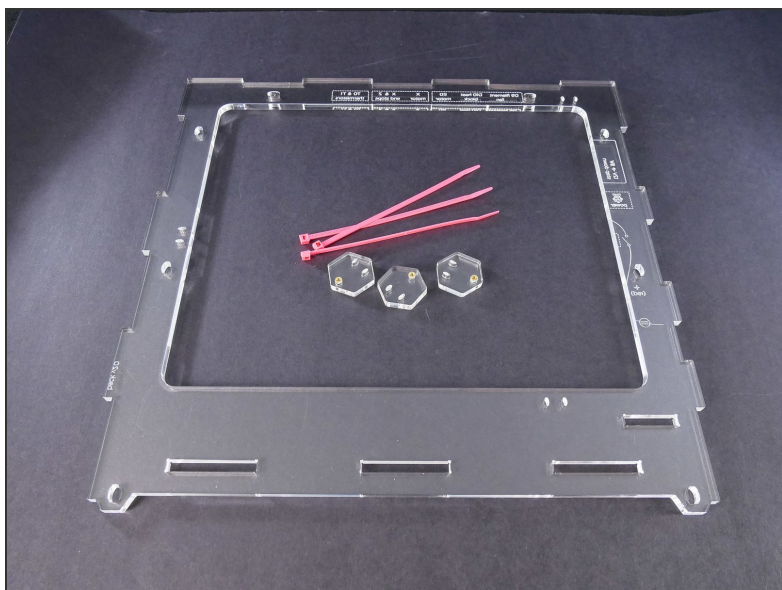

Step 2



Step 3

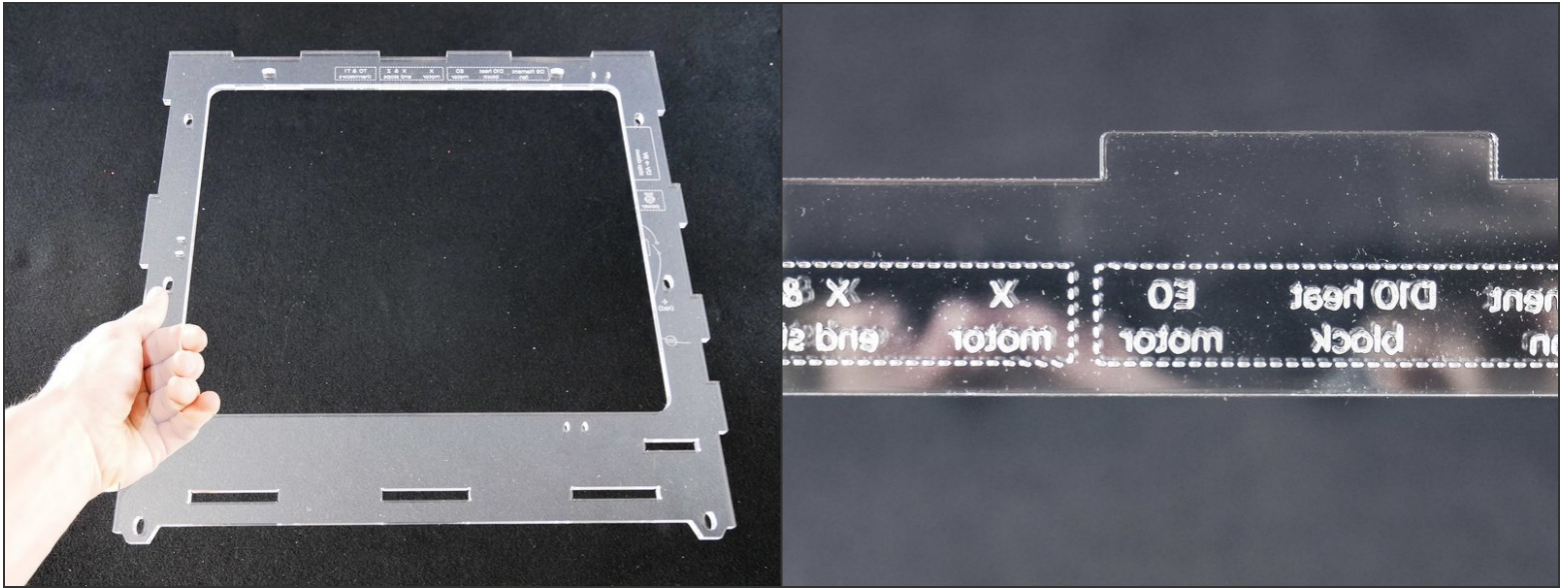

☑ Make sure your *Back* piece is oriented as in the picture.

- All the text should be **mirrored** and **unreadable**.

Step 4

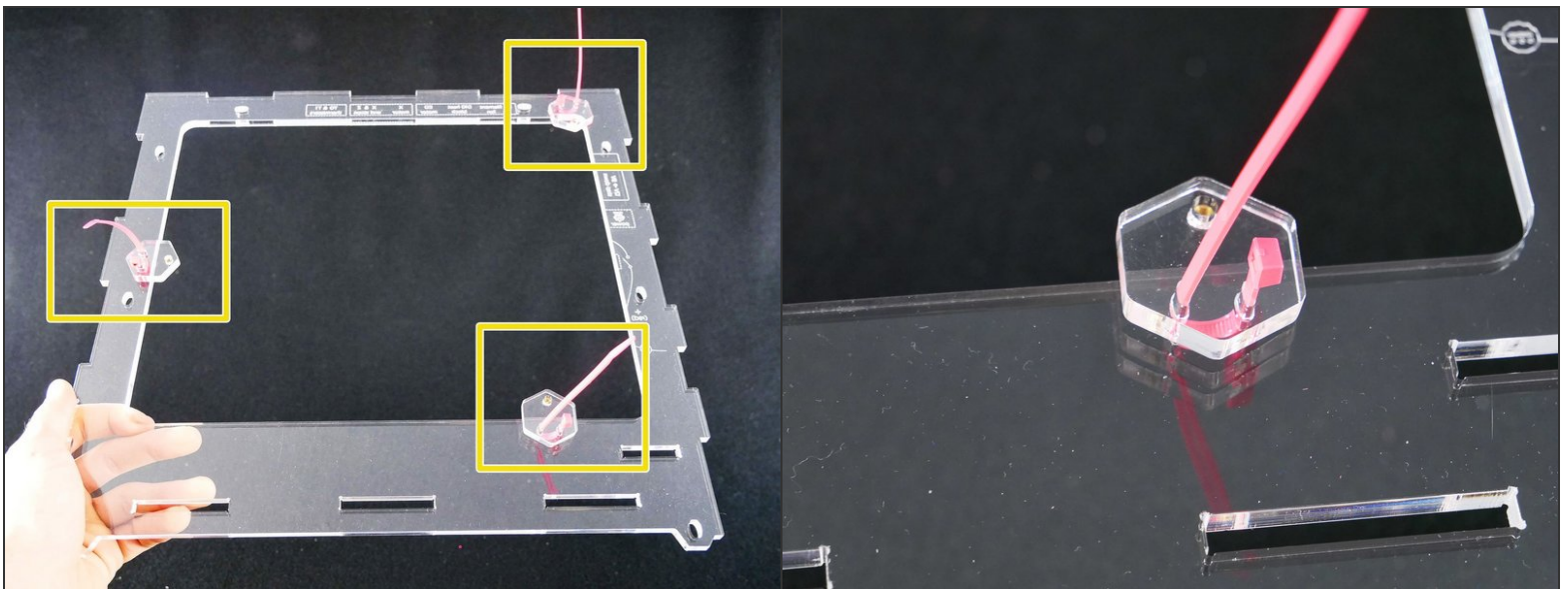

Step 5

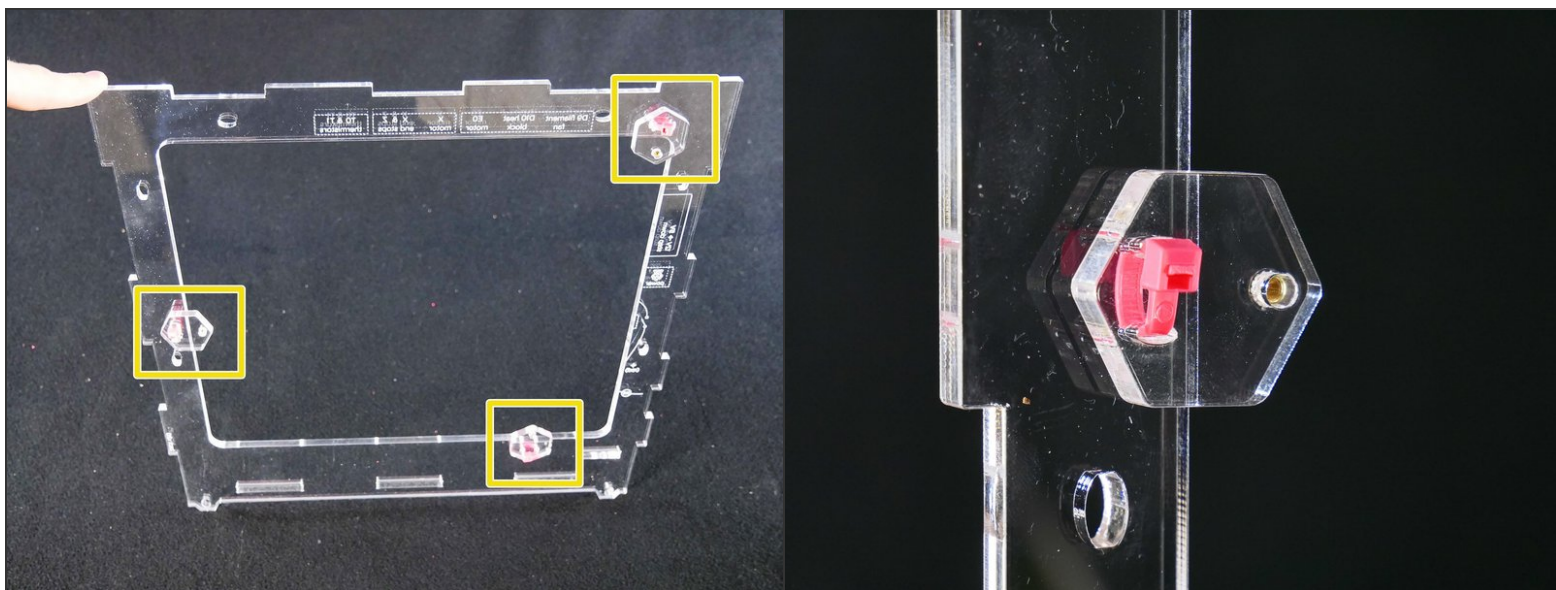

Step 6

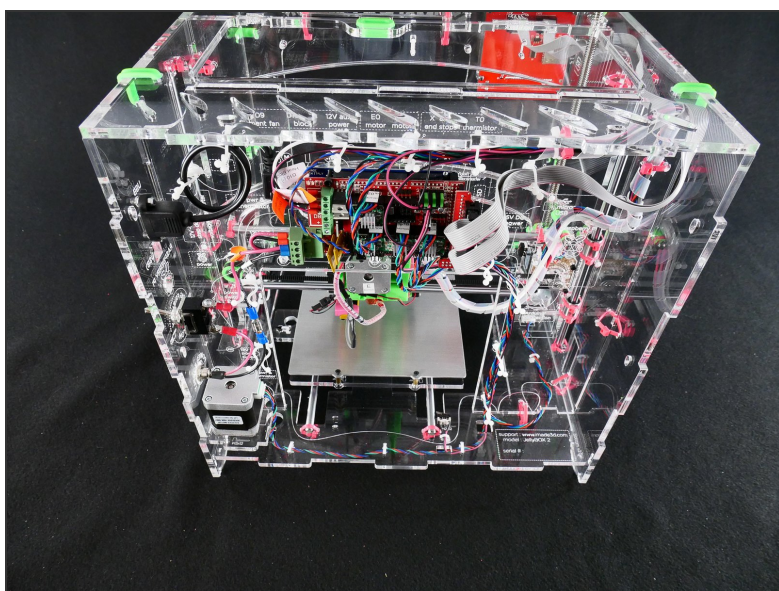

Step 7

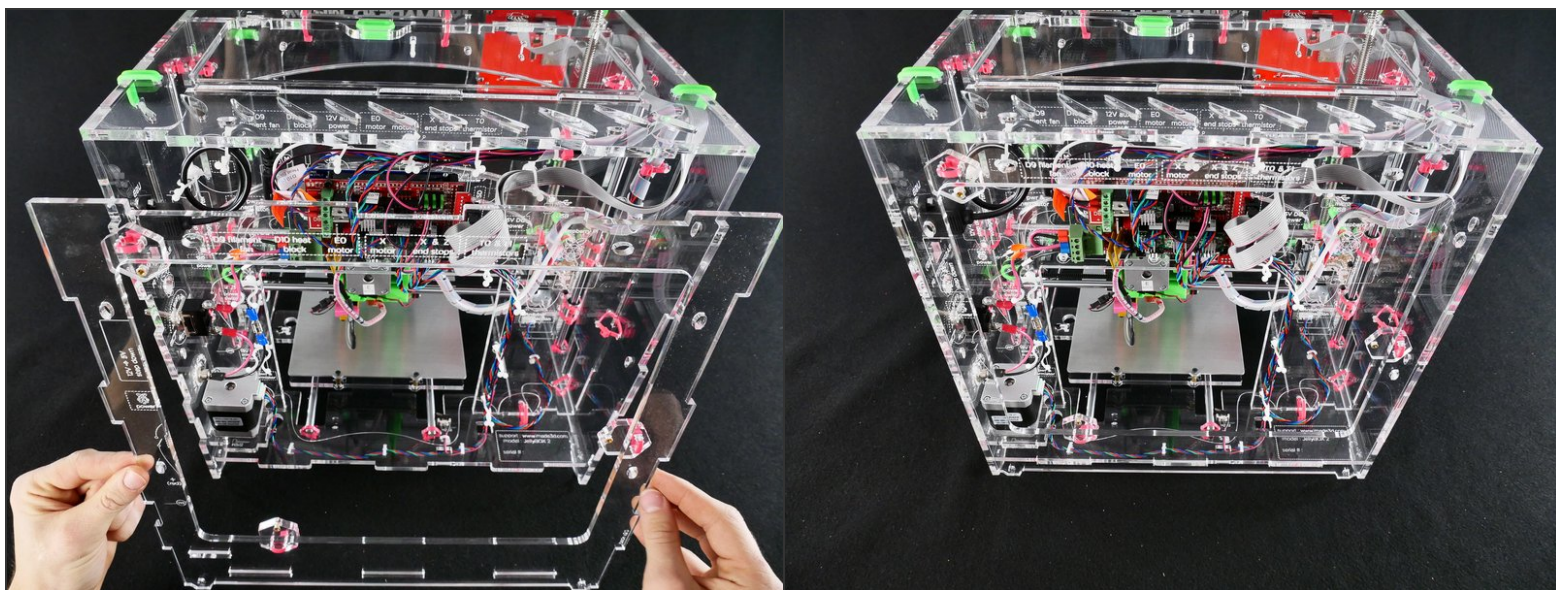

Step 8

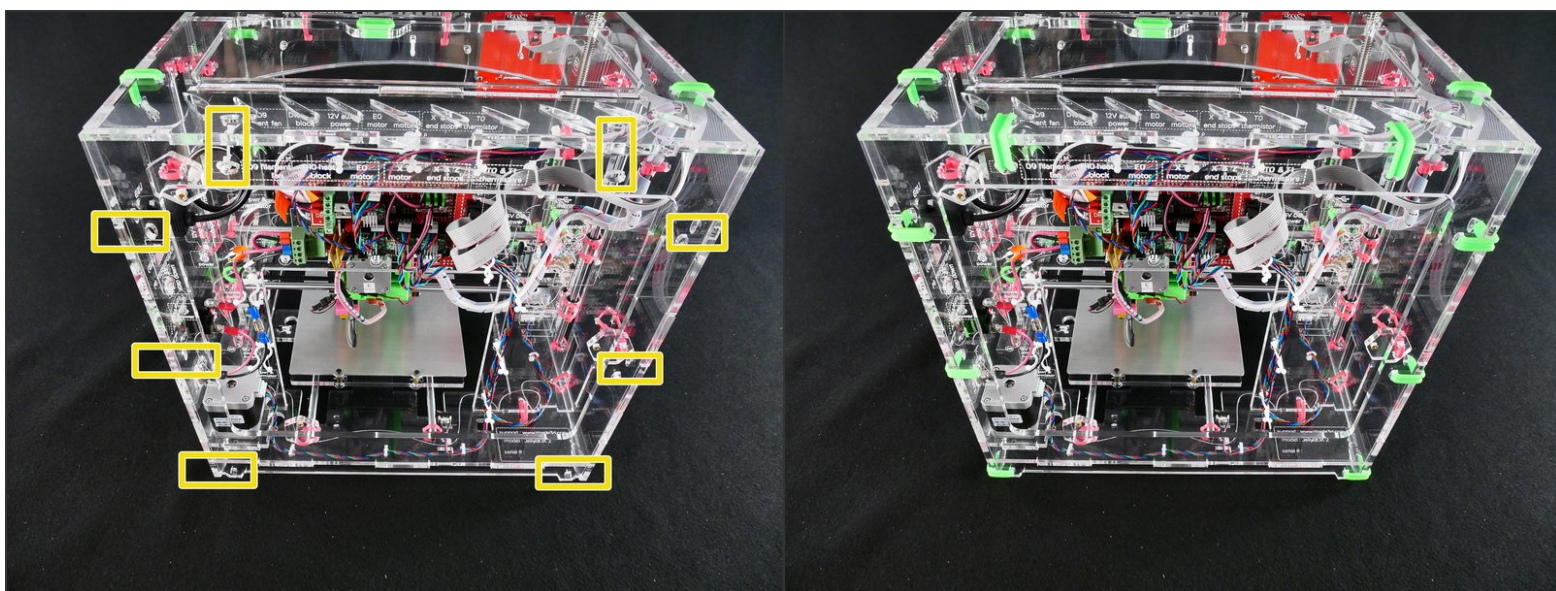

What's Next?

Get back to the [← Easy Kit Build Flow](#) and continue with the next guide.