

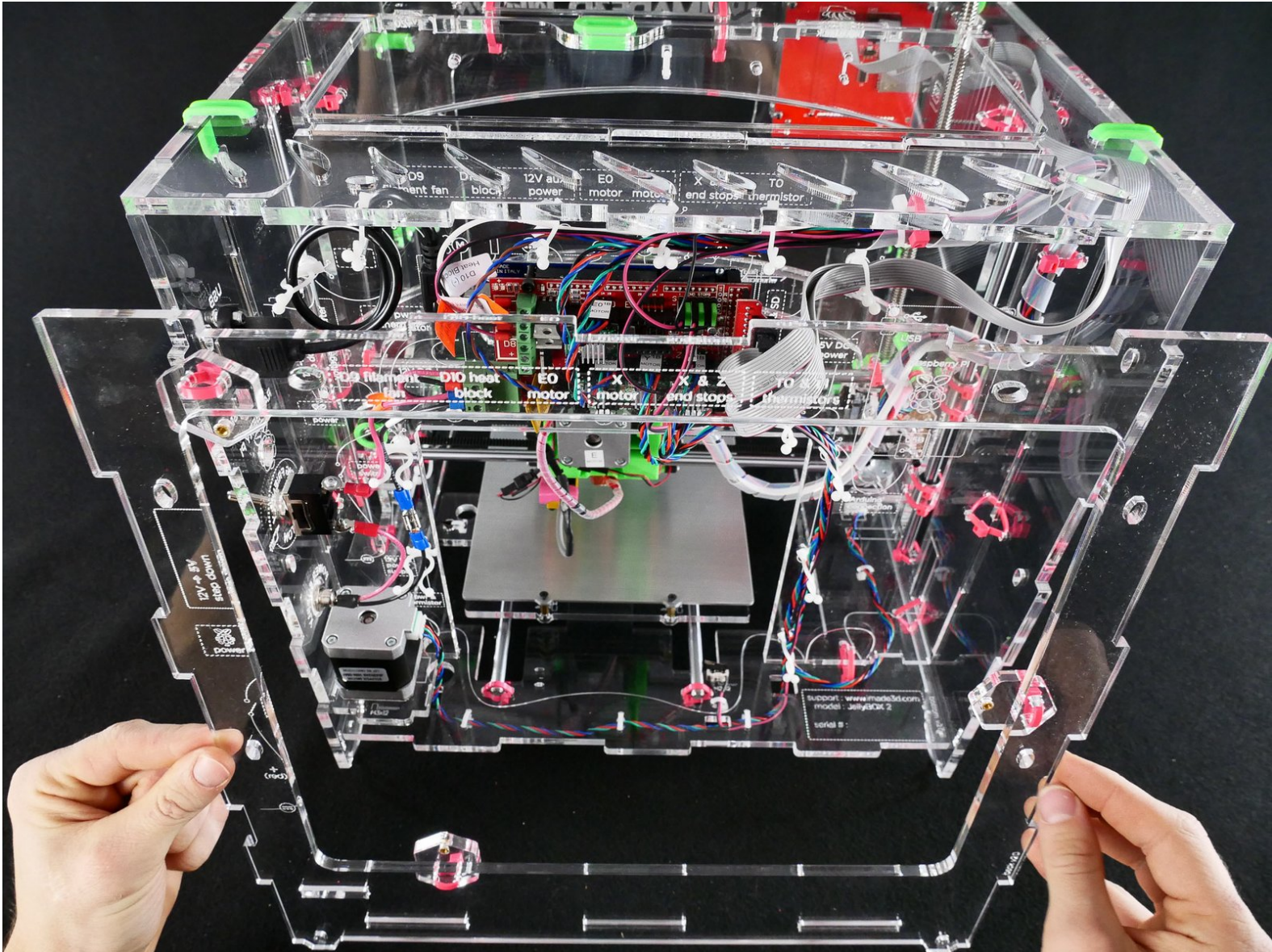

# TEST Duplication Source

TEST Duplication Source



# INTRODUCTION

Not the guide you are looking for?

Go back to the [← Easy Kit Build Flow.](#)



## Step 1 — ↳ Prepare the Back

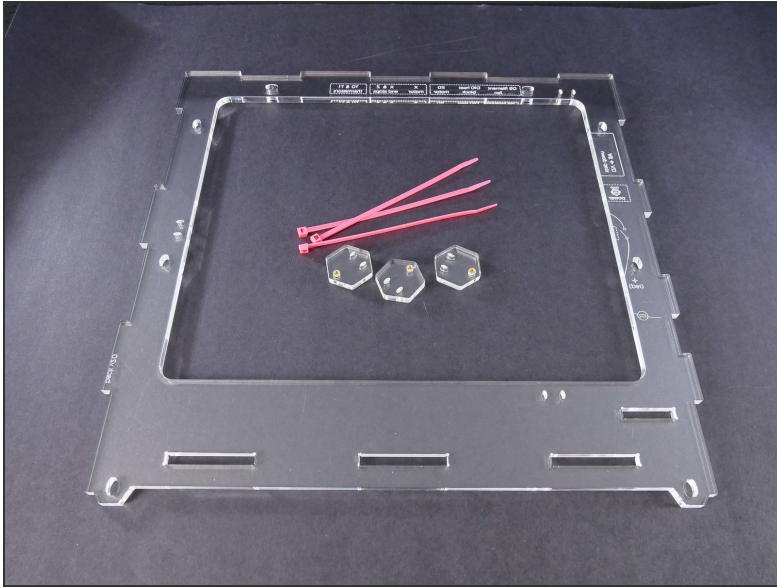

## Step 2

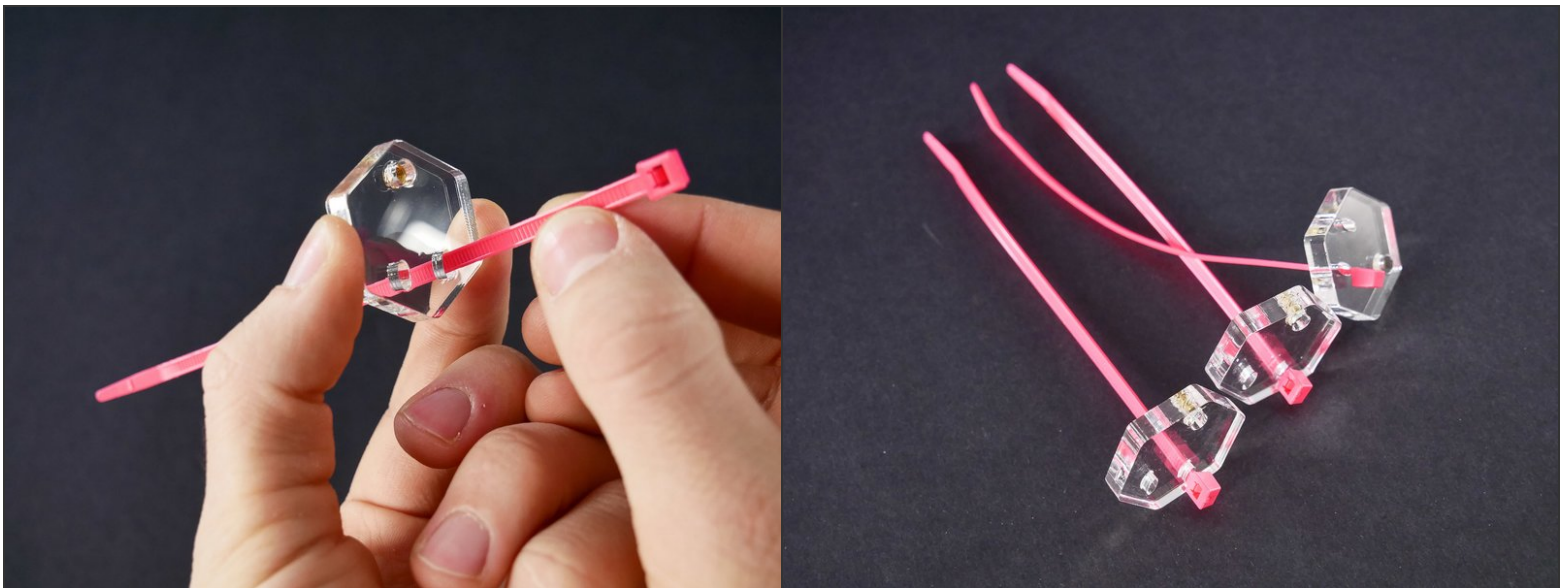

### Step 3

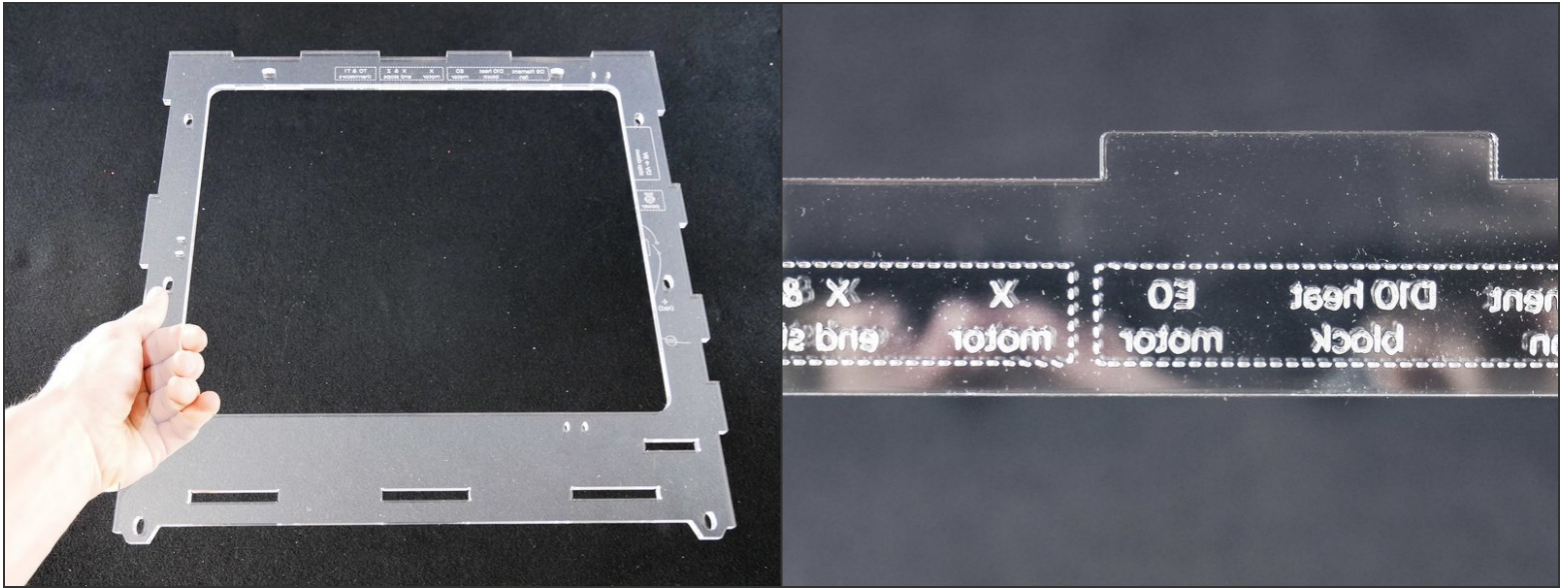

☑ Make sure your *Back* piece is oriented as in the picture.

- All the text should be **mirrored** and **unreadable**.

### Step 4

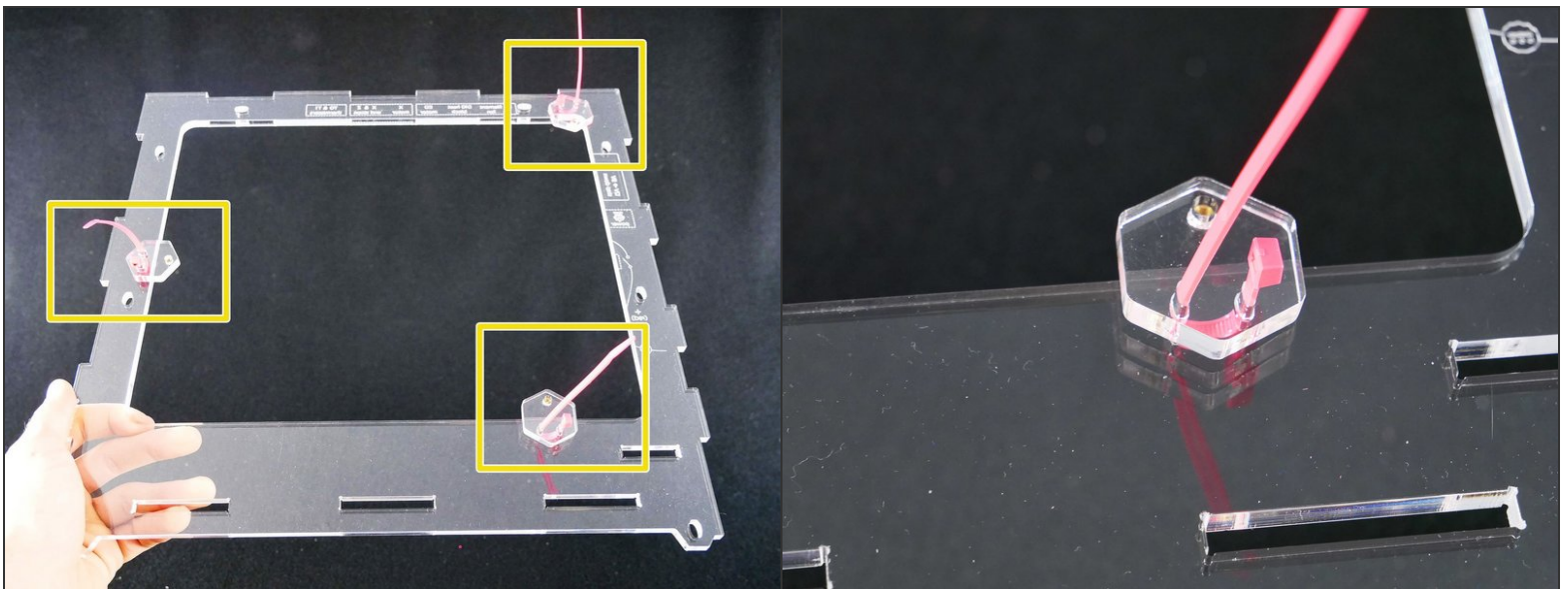



## Step 5

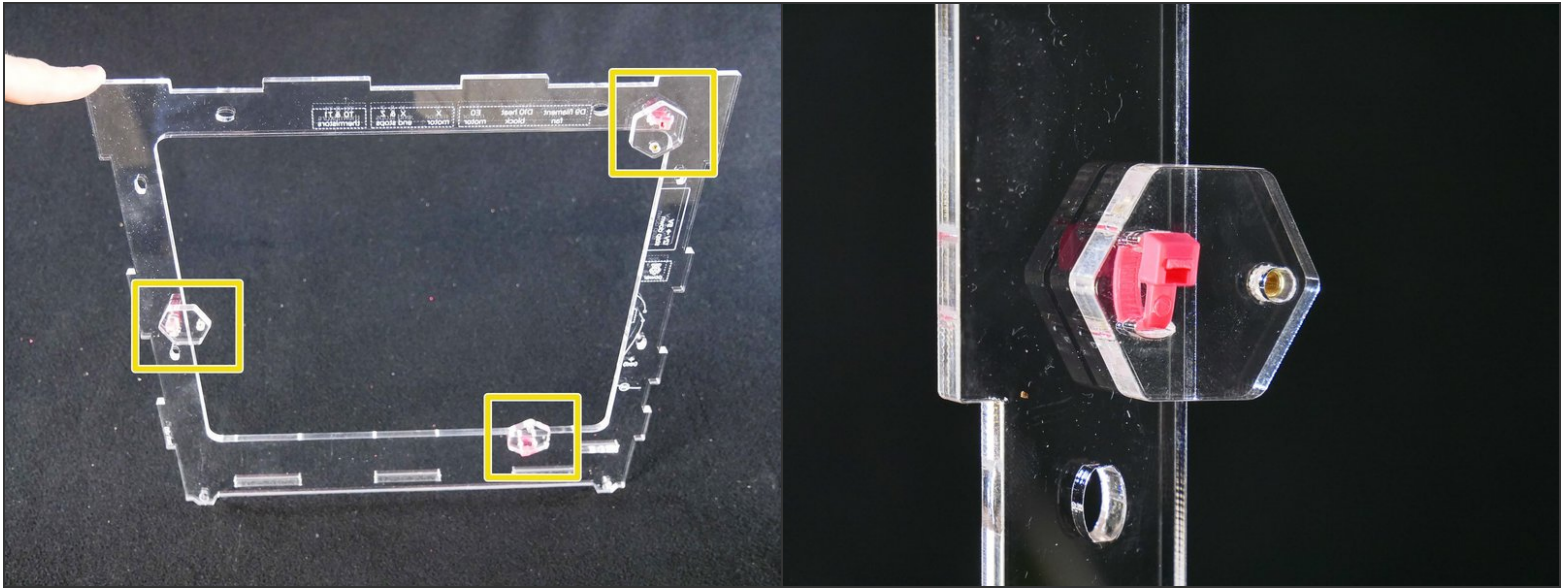

## Step 6 — ↳ Install the Back

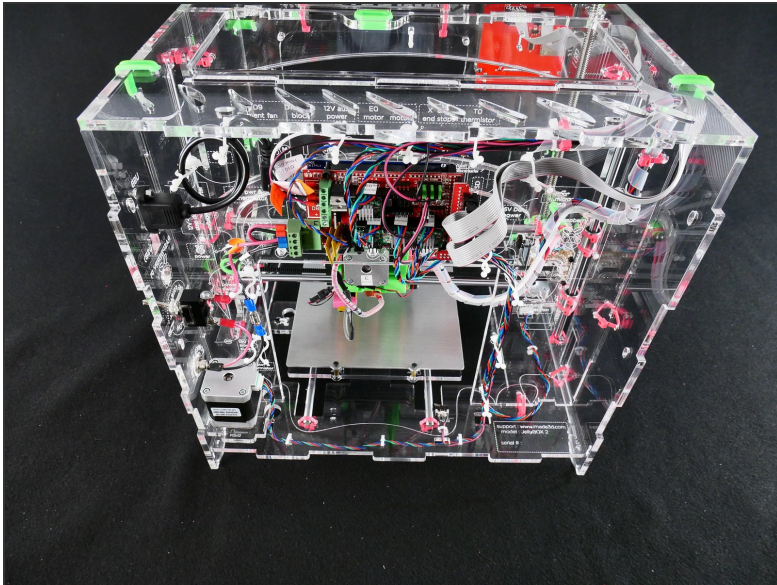



## Step 7

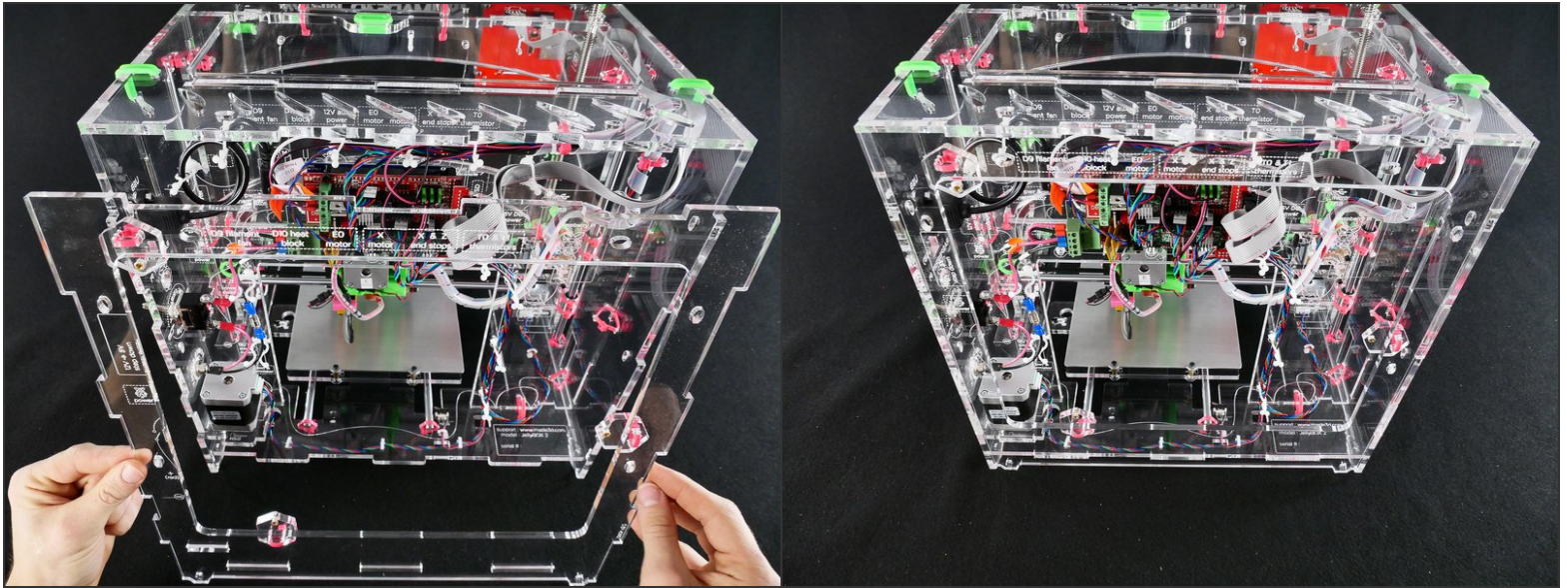

## Step 8

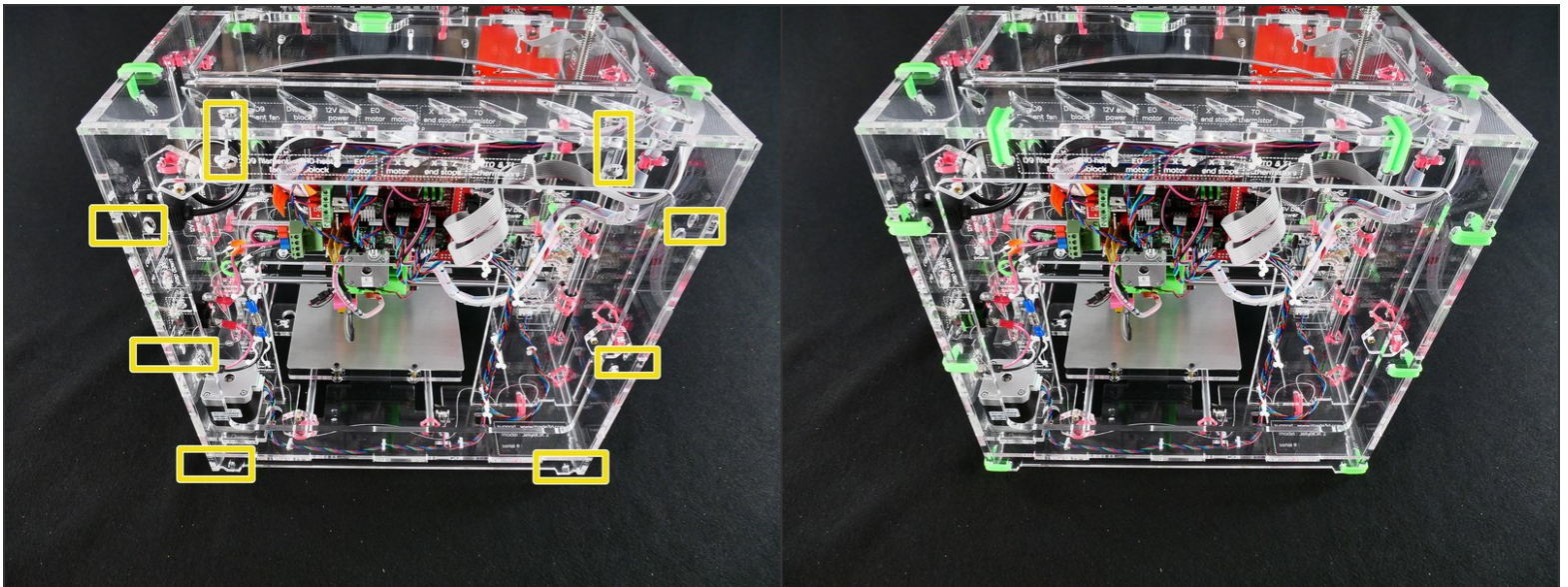

## What's Next?

Get back to the [← Easy Kit Build Flow](#) and continue with the next guide.