



# Print the Part Scraper



# INTRODUCTION

Not the guide you are looking for?

Go back to the [← Easy Kit Build Flow.](#)

## Step 1 — ↪ Print the Part Scraper

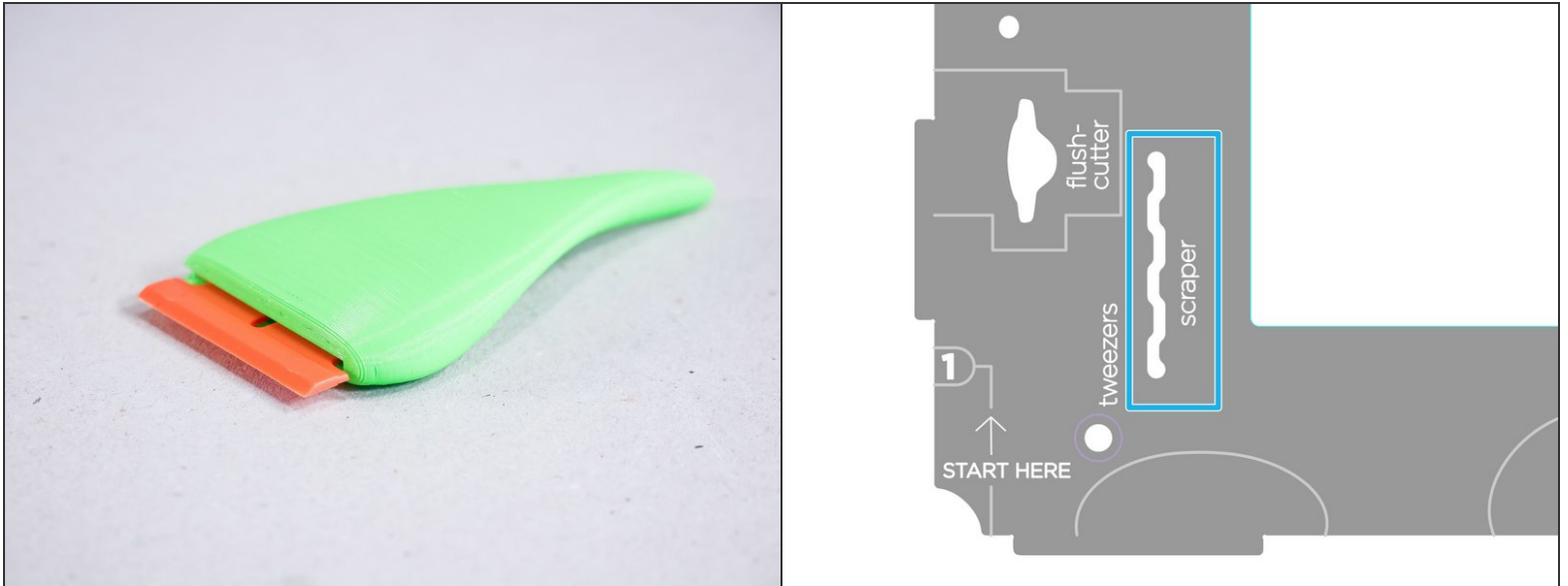

- The Part Scraper shall help you remove the printed parts from the build platform without hurting yourself or printing surface.
- In the bottom left 'tool holders' area of your JellyBOX, there's a slot that holds the scraper, too!

## Step 2

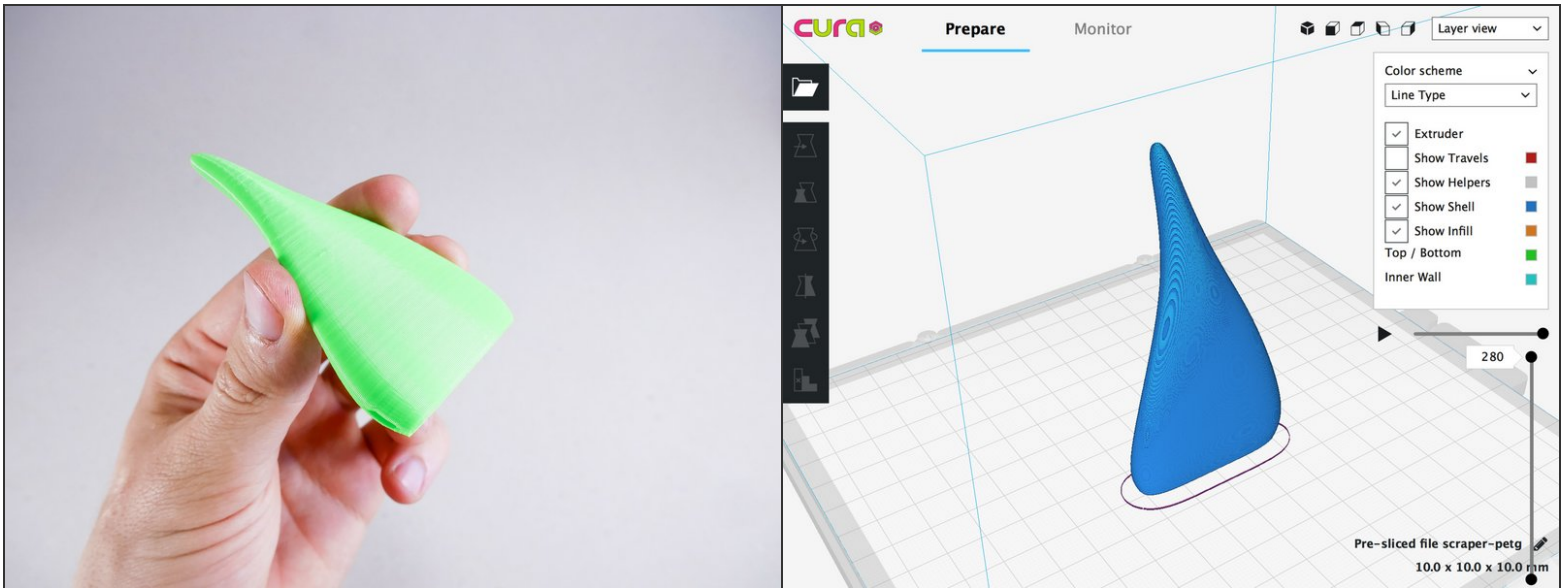

- Download your Part Scraper pre-sliced for PLA or PETG (PETG is stronger) and print it.
- [Download Scraper in PETG](#)
- [Download Scraper in PLA](#)
- If you know your way around Cura, here's a [3mf file](#) if you want to tinker.

⚠ If you have troubles with the files, please checkout this short guide on [HowTo Download Gcode Files to your computer](#) (many browsers make this difficult!)

### Step 3



- This is a plastic razor blade (yes, plastic razor blade). It's not as sharp as a metal one, and it gets damaged, but it's cheap and it cannot damage any print surface or seriously hurt anyone.
- Your razor may be a different color than orange. Notably, black!
- ❗ Plastic razors are used in the automotive industry to scrape off stickers from windshields and the car bodies - because they do not damage the car.

### Step 4 — It's done!



## Step 5

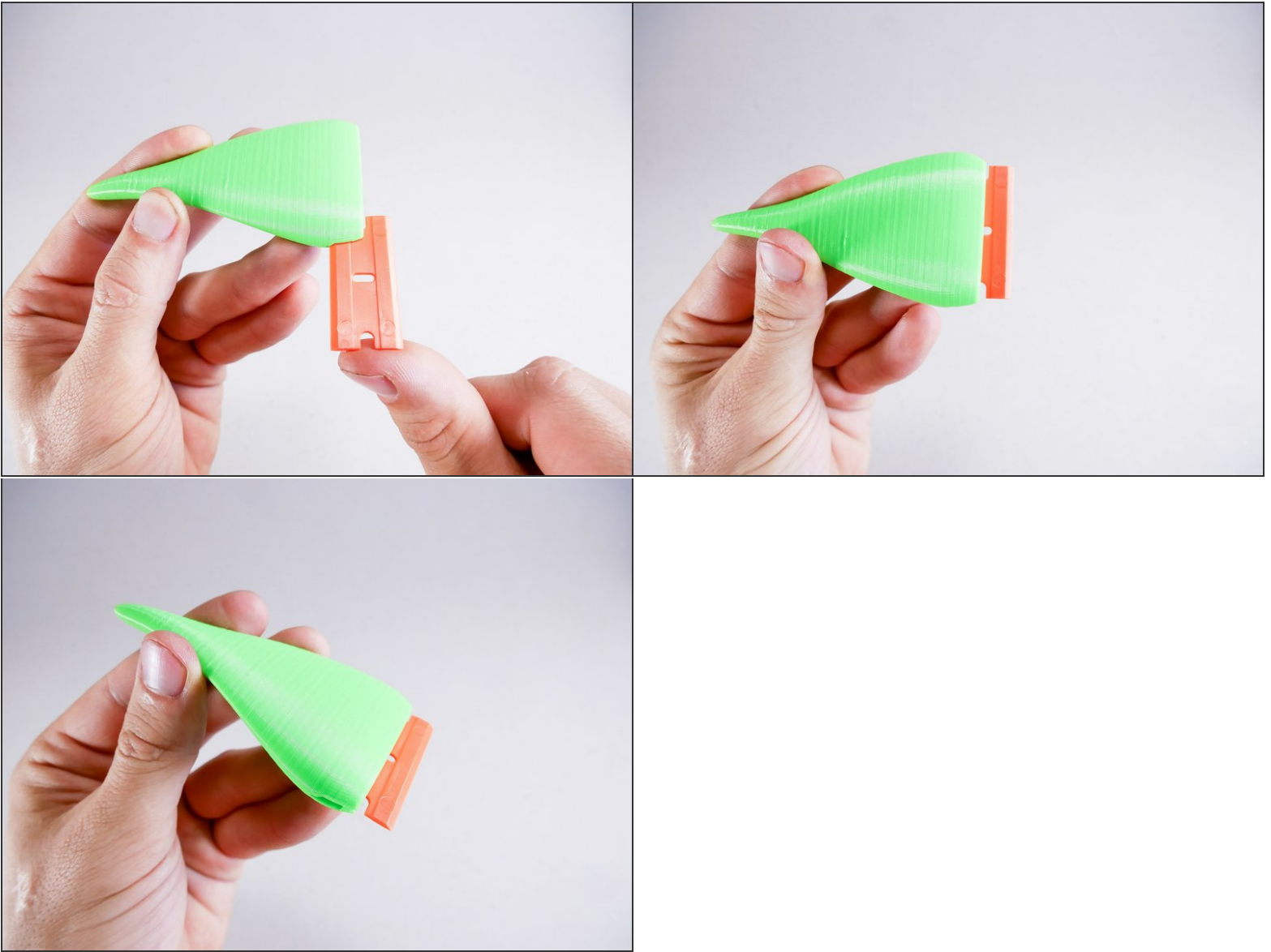

## What's Next?

Get back to the [← Easy Kit Build Flow](#) and continue with the next guide.