

[illegible]

INTRODUCTION

Not the guide you are looking for?

Go back to the [← Easy Kit Build Flow.](#)

Step 1 — ↳ Prepare the Back

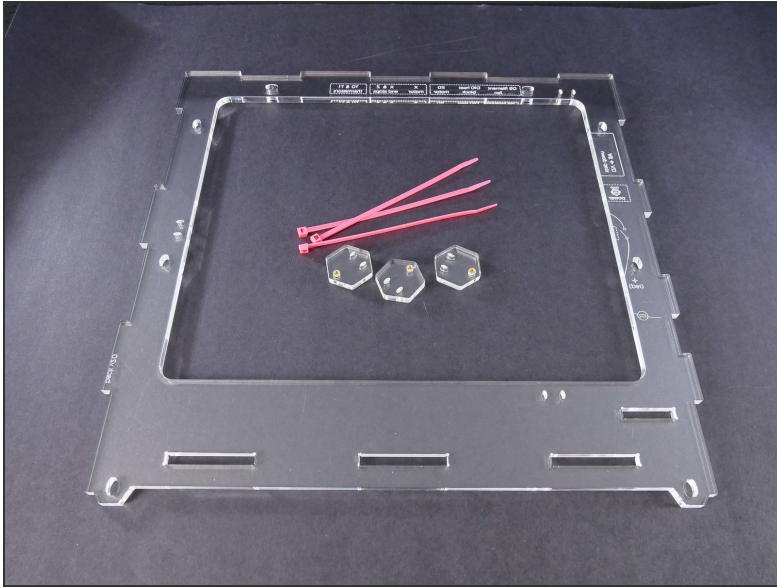

Step 2



Step 3

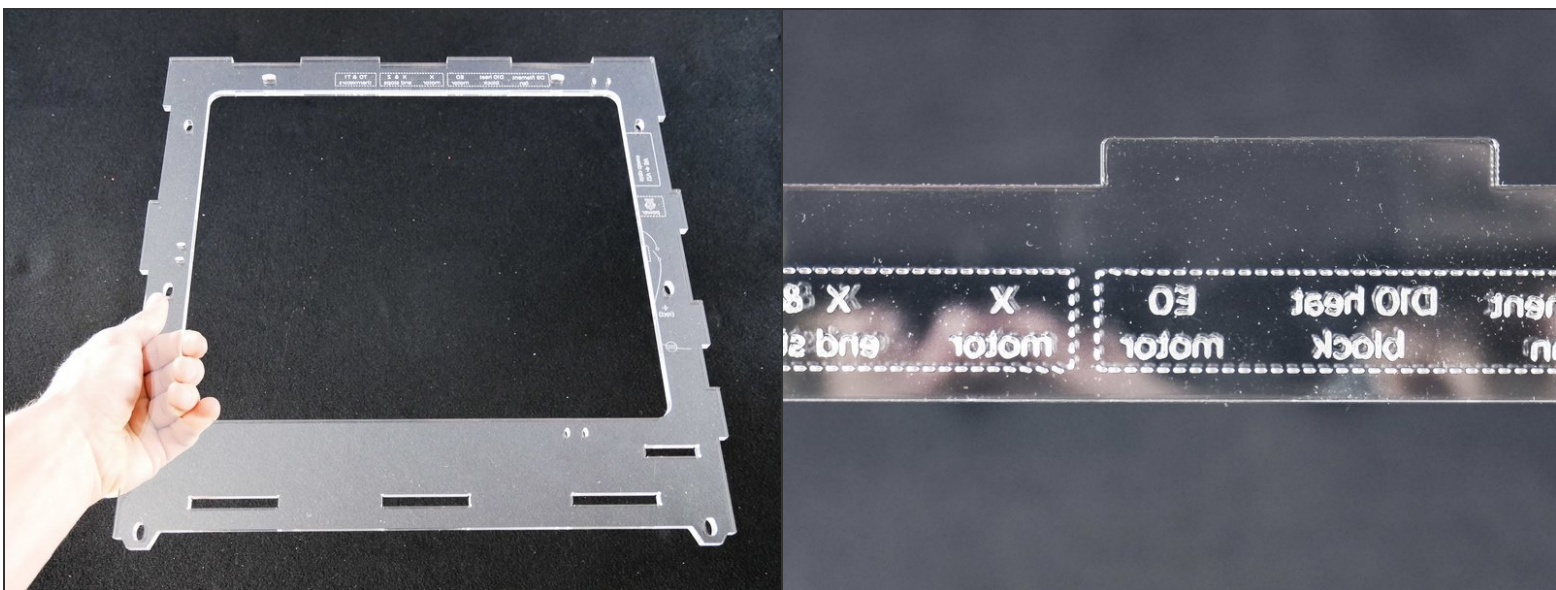

- Make sure your *Back* piece is oriented as in the picture.
- All the text should be **mirrored** and **unreadable**.

Step 4

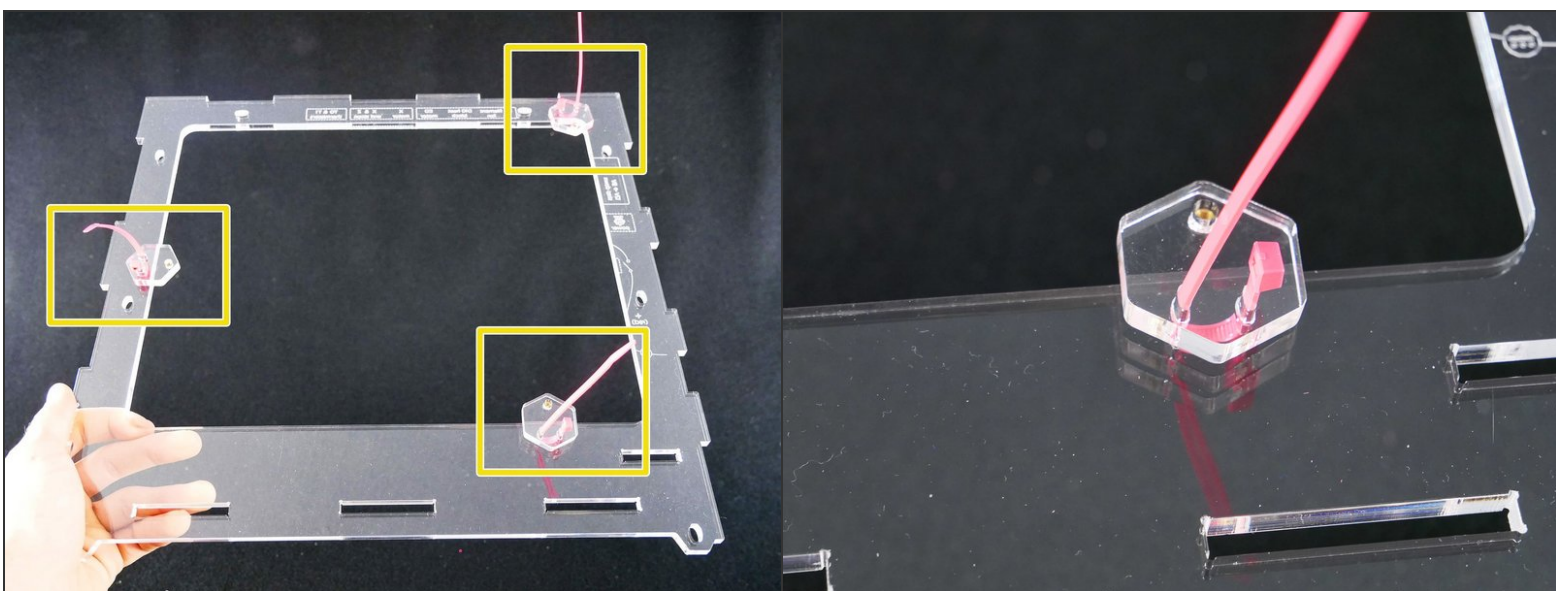

Step 5

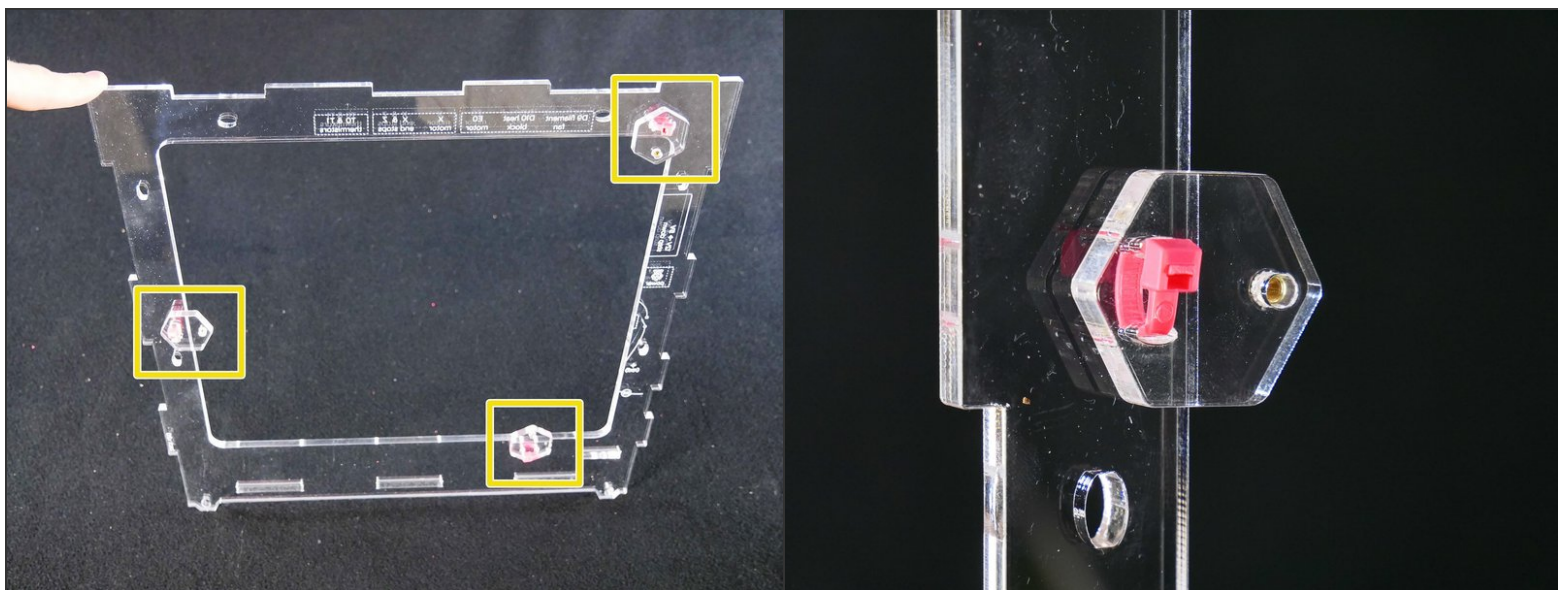

Step 6 — ↳ Install the Back

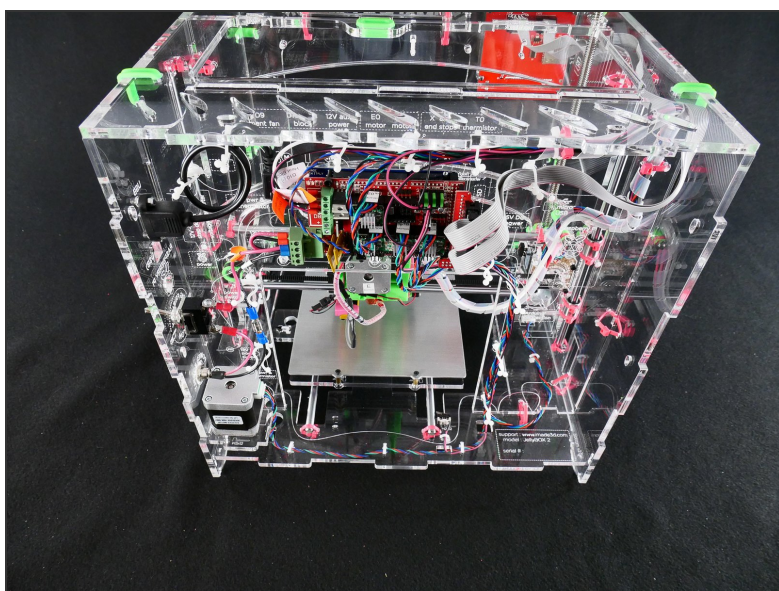

Step 7

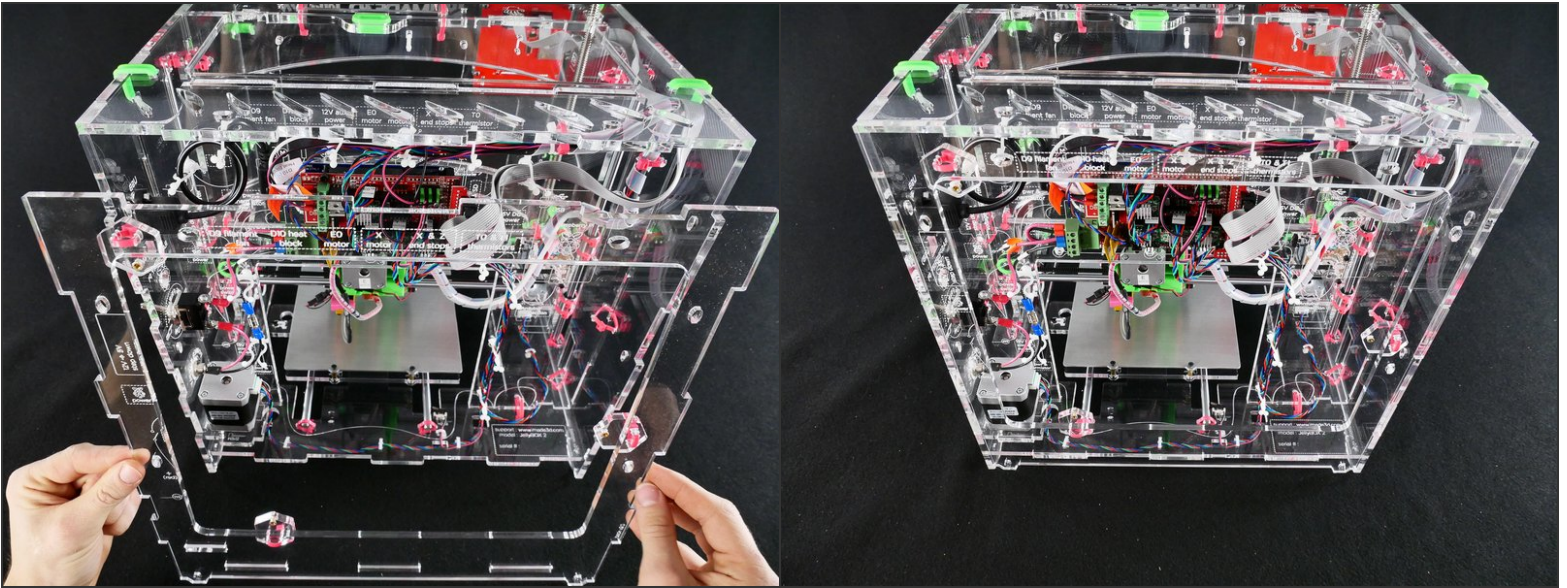

Step 8

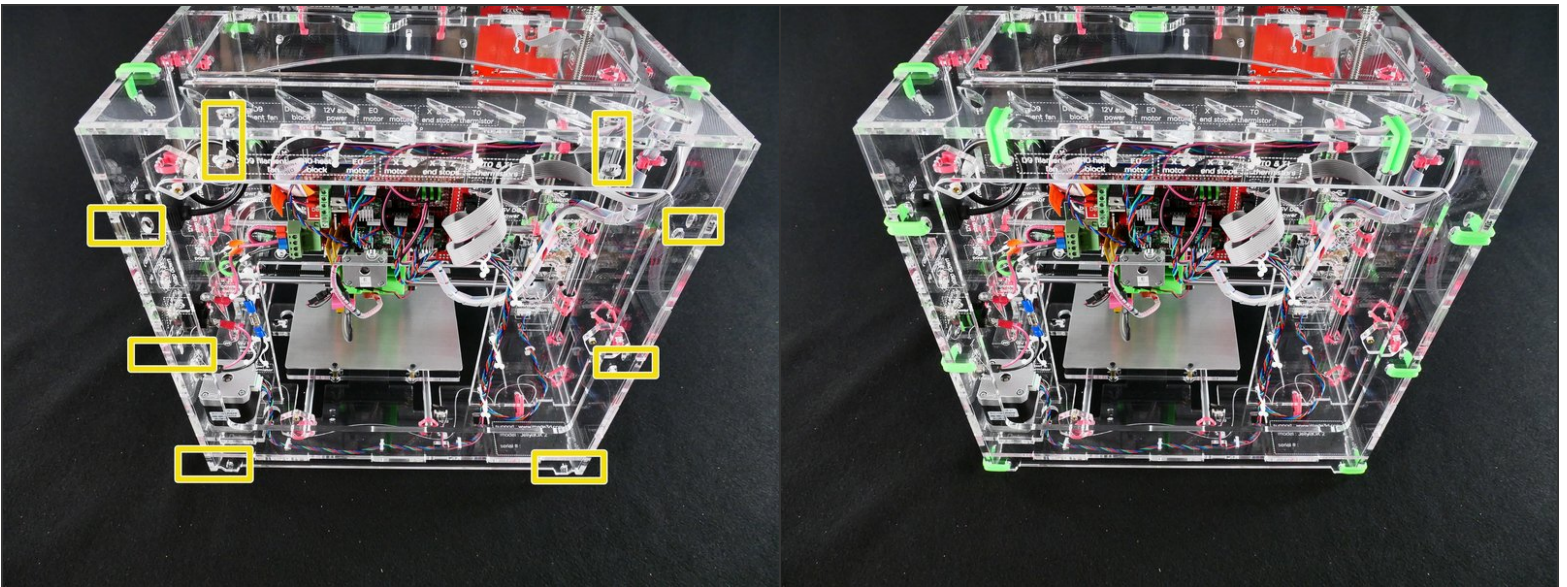

What's Next?

Get back to the [← Easy Kit Build Flow](#) and continue with the next guide.