

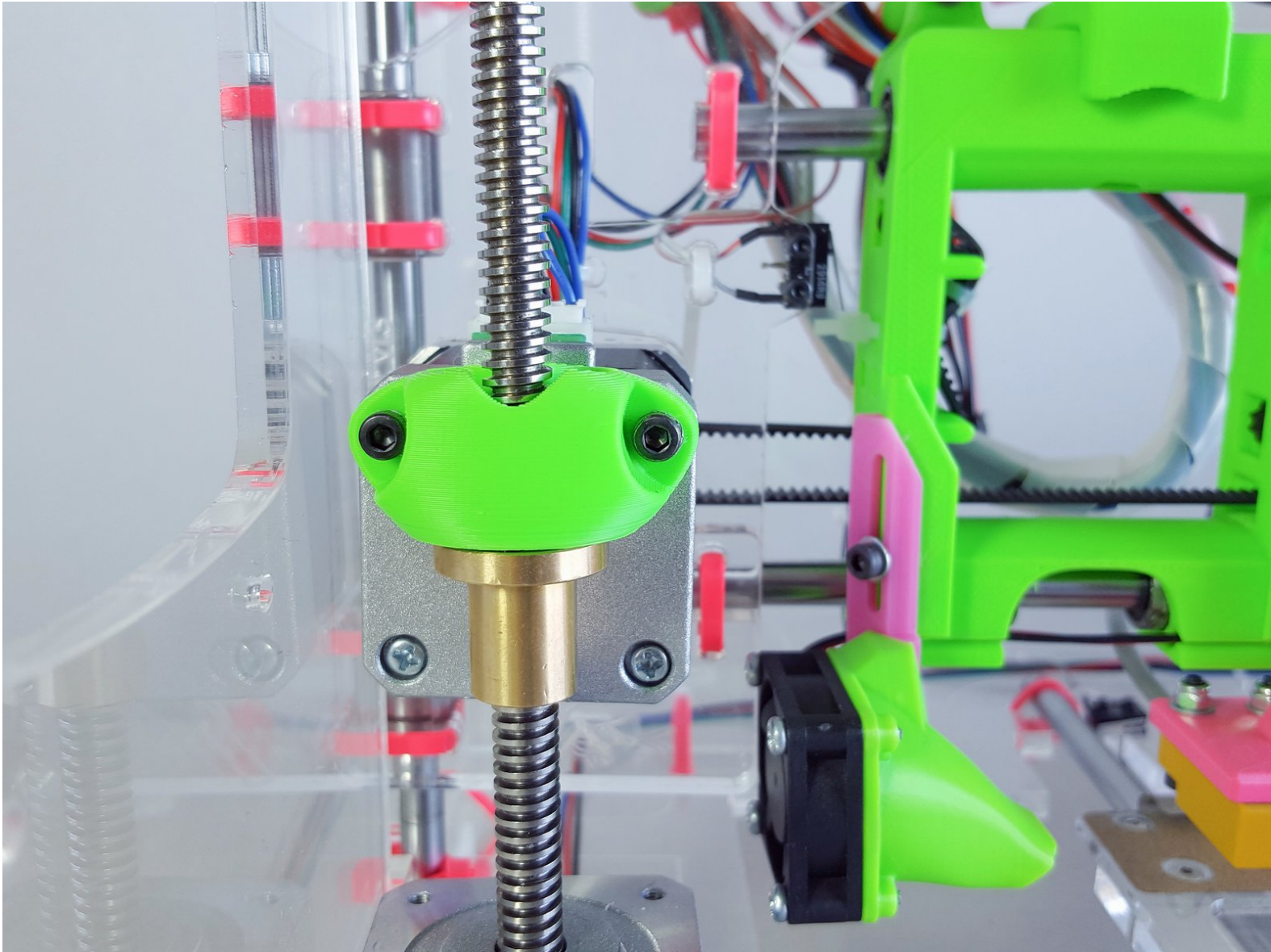

# Install the ZX Coupler

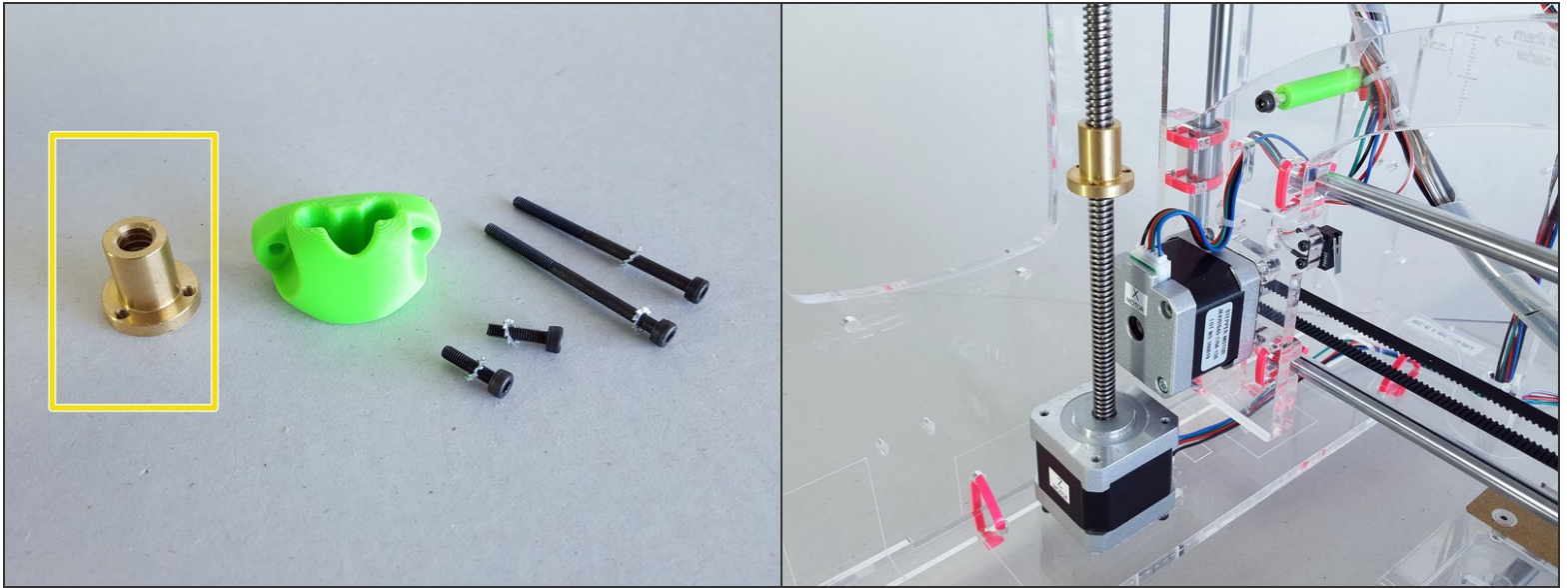

## Step 1 — ↪ ZX Coupler



- Brass flange nut (trapezoidal thread)
  - The flange nut may have come pre-installed on the Z motor lead screw. In that case, take it down.
- ZX coupler
- M3x12 screws + M3 serrated washers
- M3x45 screws + M3 serrated washers

## Step 2

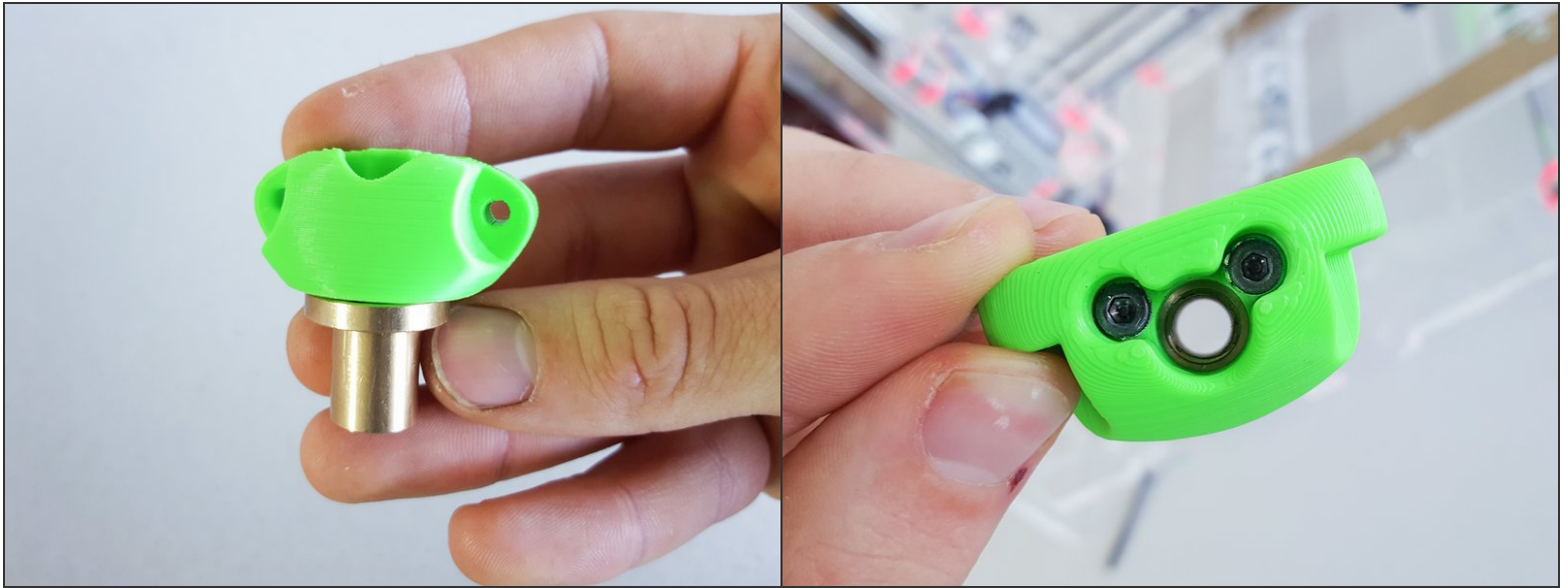

- M3x12 screws + M3 serrated washers

## Step 3

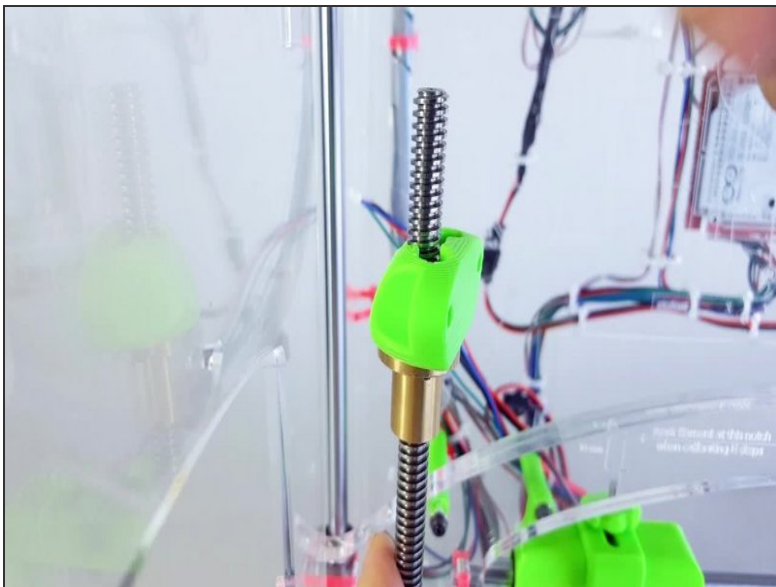

- Screw the coupler onto the lead screw; nut facing down.

## Step 4

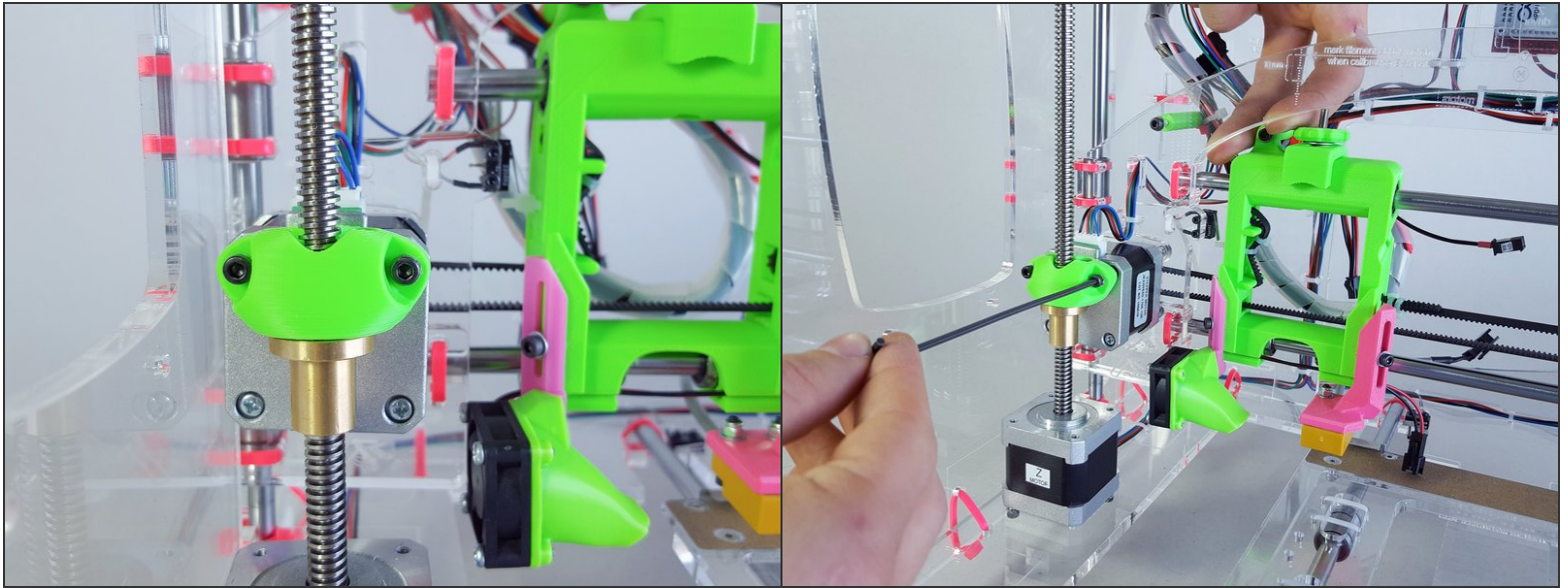

- M3x45 screws + M3 serrated washers
- The screws screw *into* the top two holes in the X motor.
- Leave the screws a bit loose.

## Step 5 — ↪ Align the Z Motor

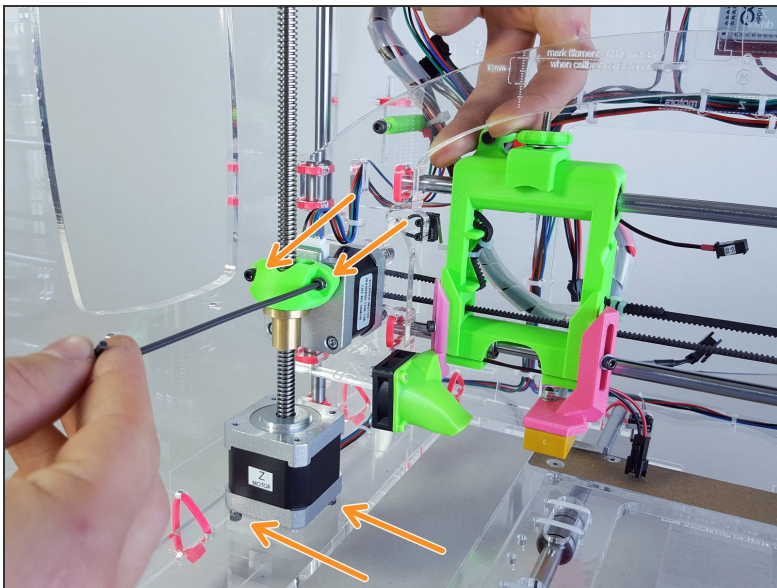

- Make sure the ZX coupler AND the Z motor screws are loose.

## Step 6

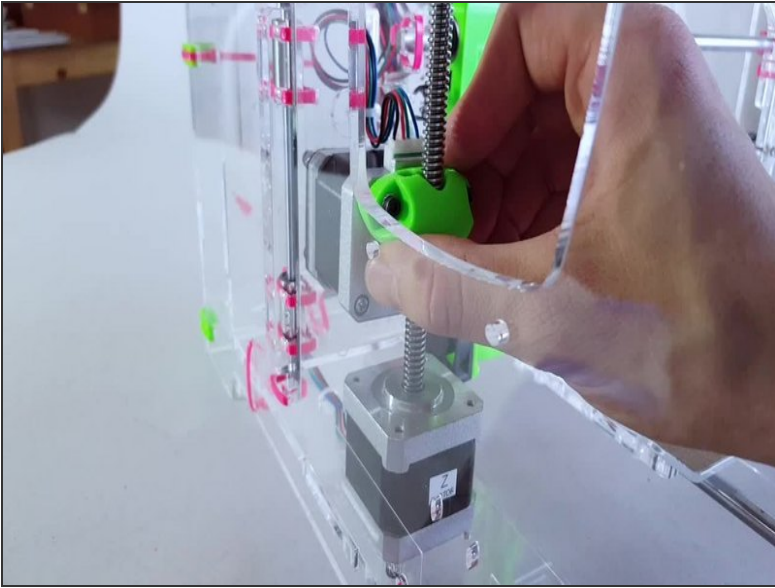

- Make the parts self-align.
- Rotate the Z lead screw by hand to find the Z motor position in which the movement is the smoothest.
- Moderately tighten both Z and X in position.
- Do not over-tighten.
- ☒ Put the printer on the edge of a table; that way you can tighten the Z motor screws from below.