

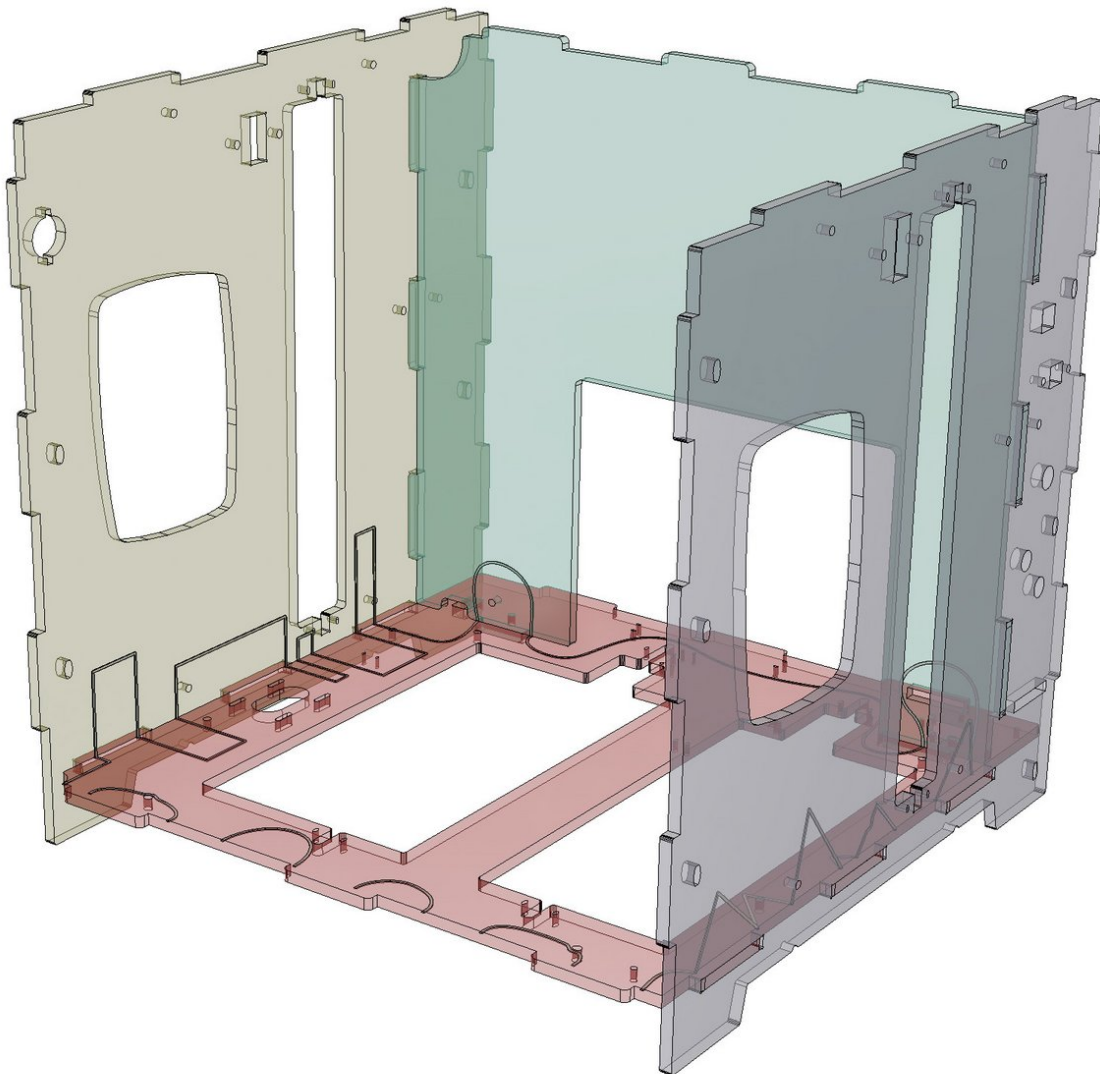

Basic Frame

In this guide, we put together the basis of the JellyBOX frame.



INTRODUCTION

In this guide, we put together the basis of the JellyBOX frame, or, "box."

Fancy an animated gif? <http://i.imgur.com/1Kzz9RE.gif>

[video: <https://youtu.be/0BfMbyGz0Y8>]

Step 1 — Basic Frame

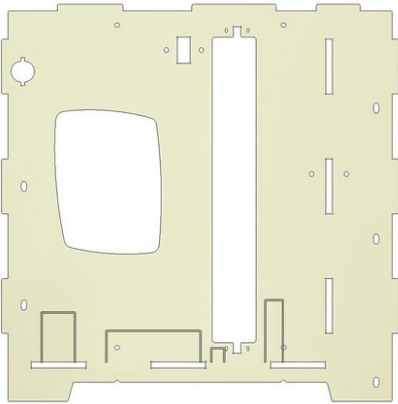
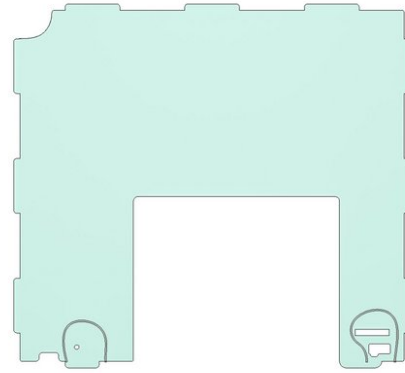
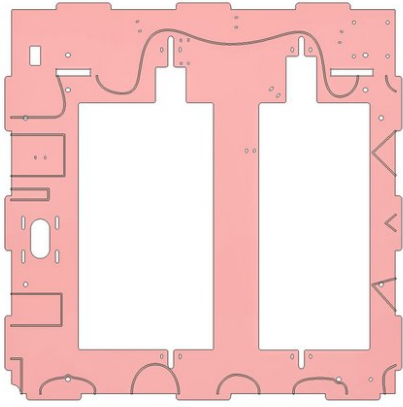

- Acrylic Bottom
- Acrylic Inner Back
- Acrylic Left

Step 2

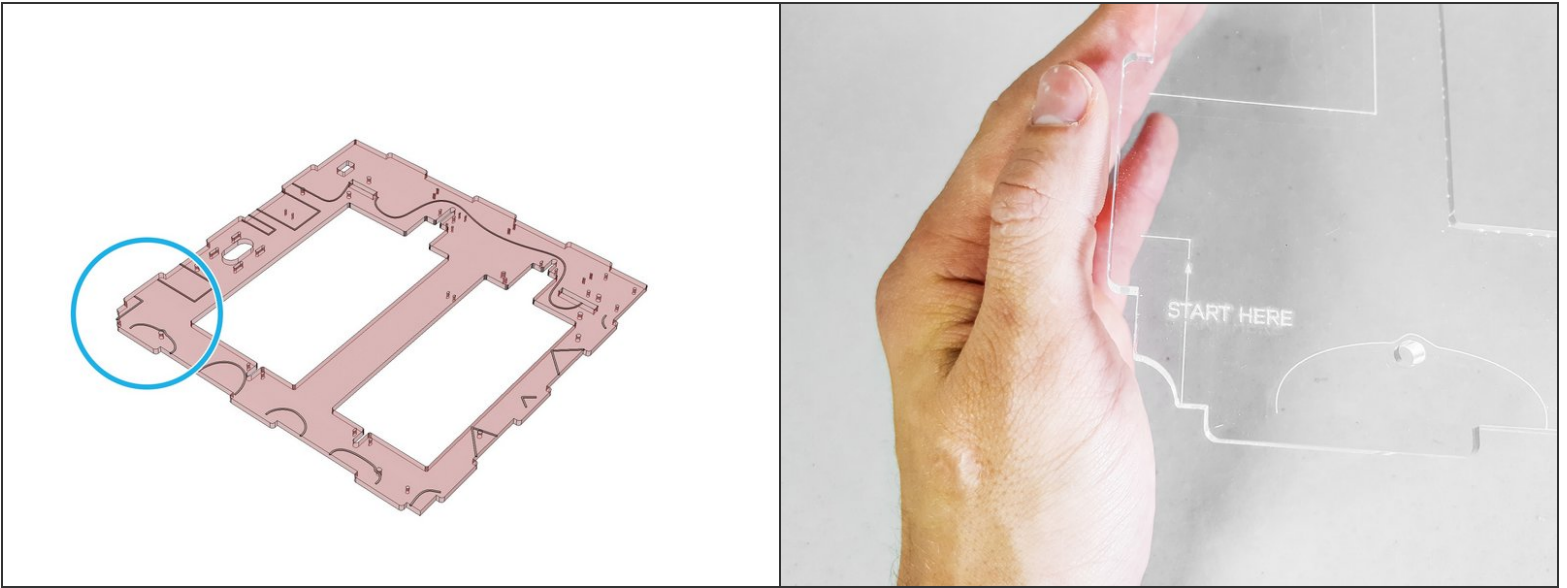

- Find "Start Here" etched on the bottom panel. That's your bottom left.

Step 3

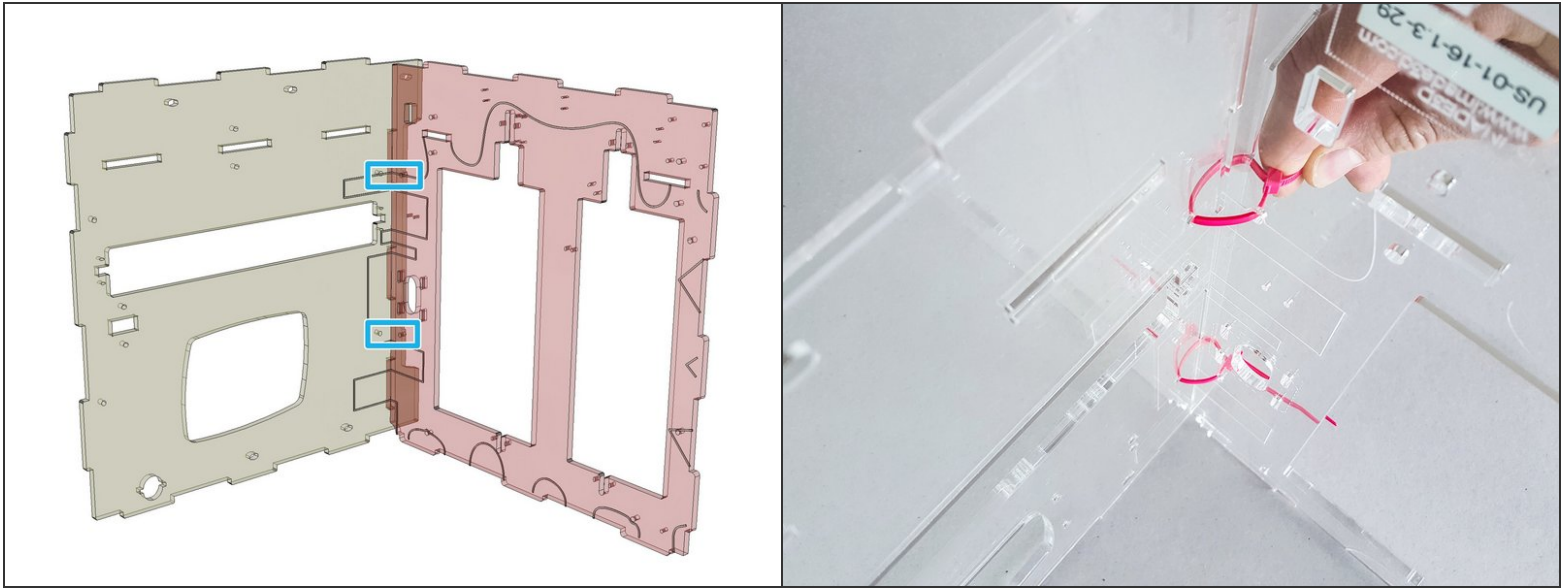

- Align the etched rectangular pattern on Bottom with Left.
- 5" zip ties
- Tighten by hand only.
- ☑ Position the zip tie heads on the bottom. (bottom of Bottom :-)

Step 4

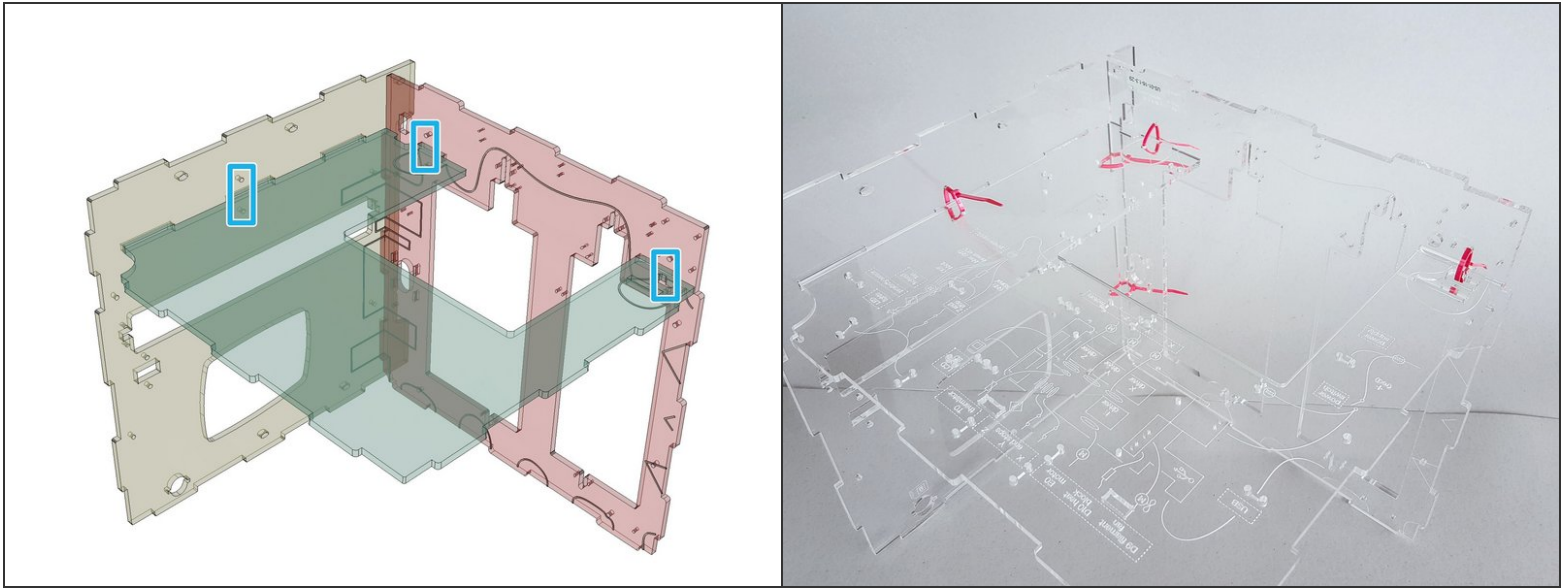

- Add the Inner Back.
 - 5" zip ties
 - Tighten by hand only.
-  Position the zip tie heads on the bottom. (bottom of Bottom :-)

Step 5

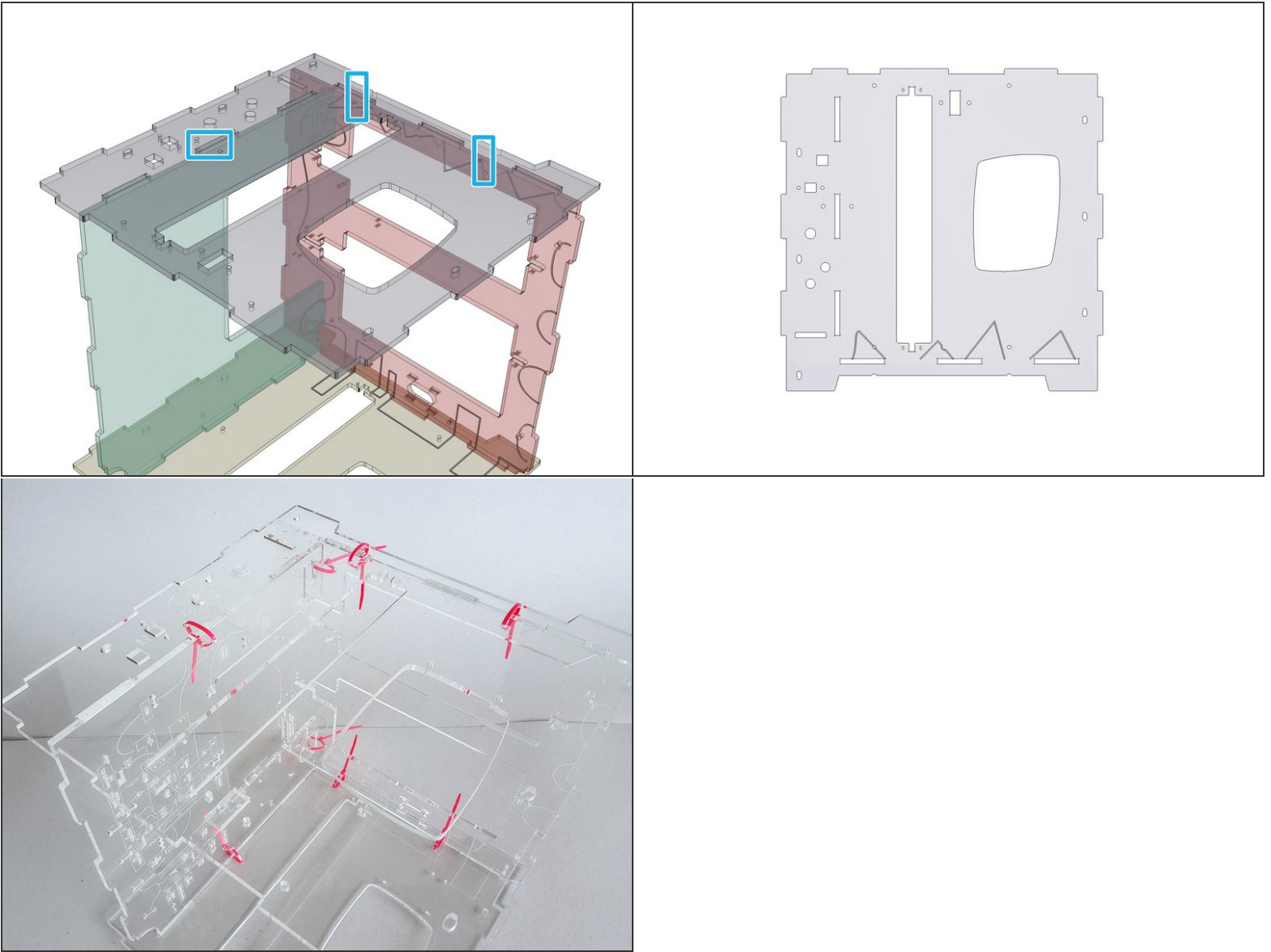

- Add Right.
- 5" zip ties
- Tighten by hand only.
- Position the zip tie heads on the bottom. (bottom of Bottom :-)

Step 6

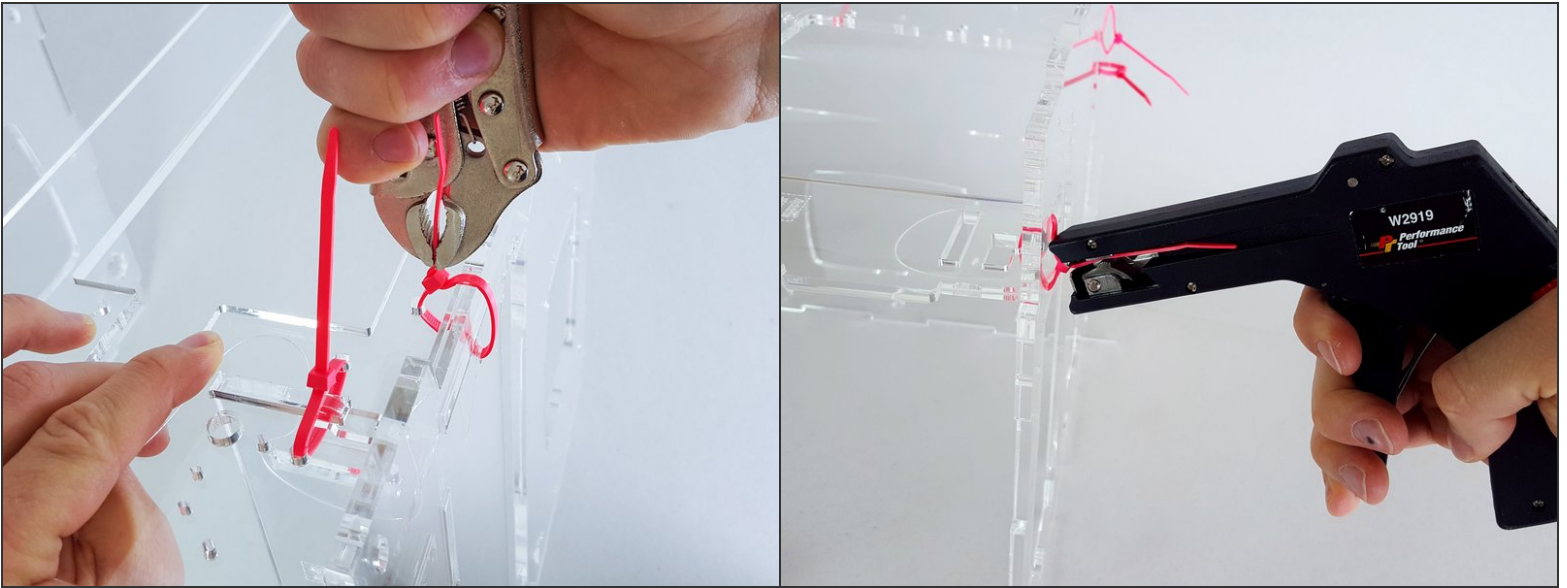

- Use vice grips to tighten the zip ties and trim the tails with your snips.
- Regular tight is enough.
- Alternatively, use a zip tie gun.

Step 7

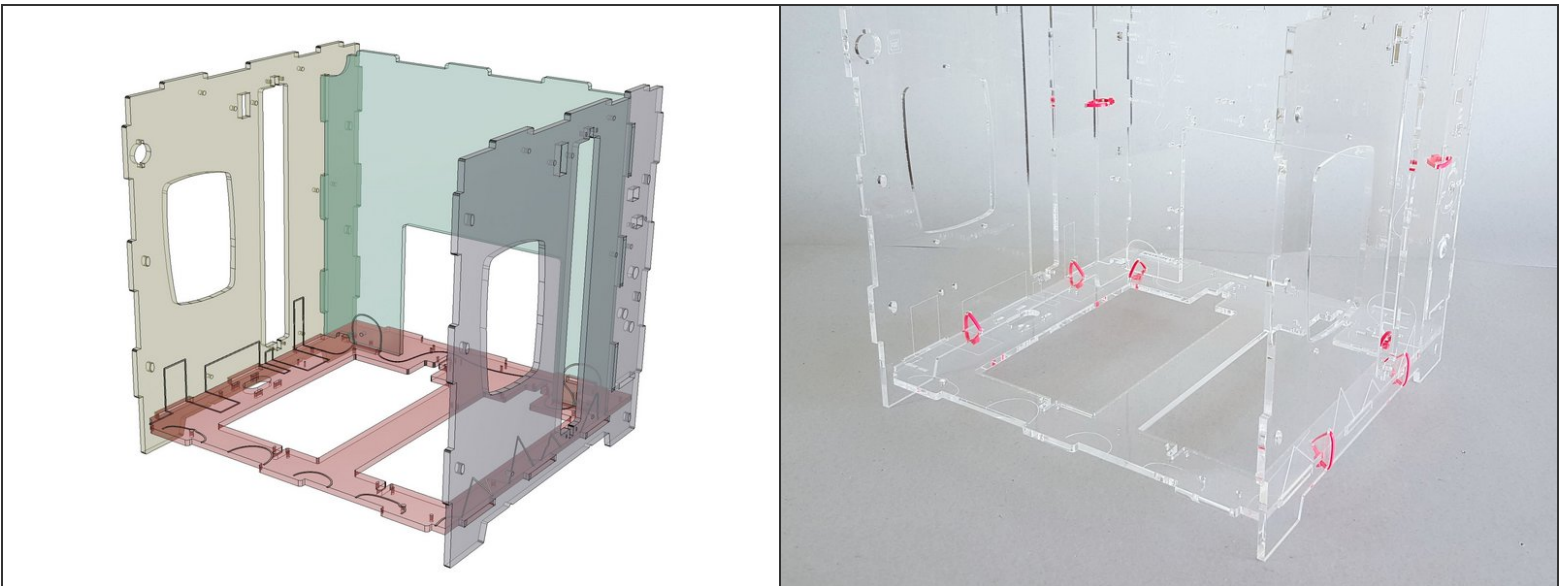

- Done.

